

FREE!



Volume 31, 2024



SCAN FOR DIGITAL VERSION OF THE OFF SHORE RELEASE

Chairman of the Boards BRUCE DESHANO
COO NICK DESHANO
Editor MARK ROMANACK

The **OFF SHORE** RELEASE

Your Leader In Trolling Technology www.offshoretackle.com



Printed by Pioneer Printing

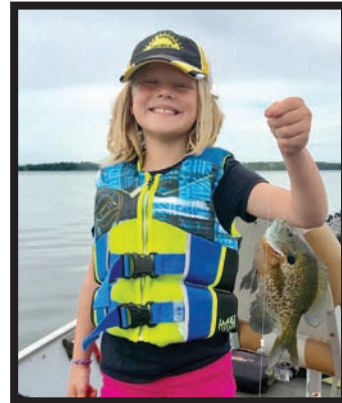
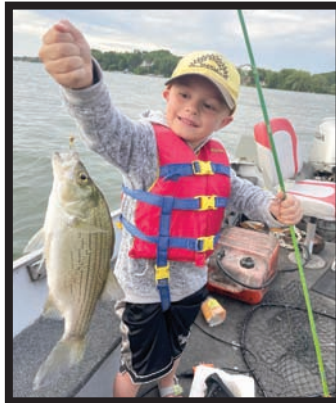
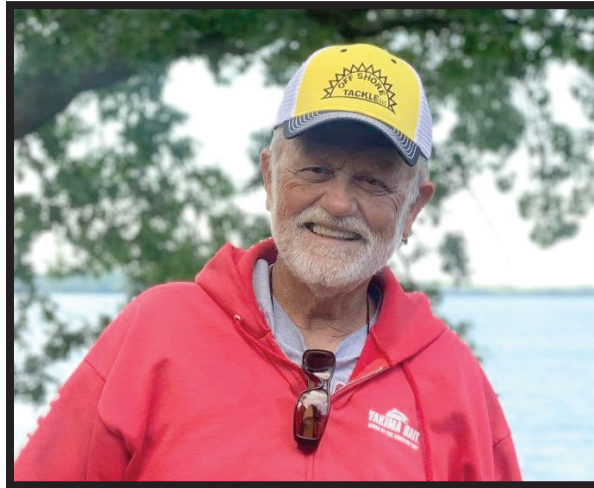

Pro staffer Michael Collins makes sure to spend as much time on the water teaching his 11 grandchildren how to fish using Off Shore Tackle equipment and enjoying the outdoors. Here are just 3 of the 11 grandchildren – Jett, Jace and Rylee Dickert.

**Tips and Techniques brought to you by
Your Leader In Trolling Technology,
Off Shore Tackle LLC.**

INVOLVING YOUTH IN COMPETITIVE ANGLING

BY JEREMY BOCK

Fishing has always been a significant part of my life. I remember my dad buying me my first rod and reel when I was pretty young and taking me across the street from our home to fish the Rock River in Hustisford, WI. Fishing really wasn't his thing, but he saw that I had interest and he helped me get started.

Over the years, my passion for fishing grew with the help and patience of my friends, cousins, and my brother-in-law. I didn't start fishing competitively as a walleye angler until I was 36 years old and have been blessed to do it the past 14 years competing in a variety of events including AIM, MWC, NWT, Mercury Marine Nationals and more. Yes, I just aged myself with those numbers.

This past summer were some of the most memorable tournaments I have fished as my two sons, Anderson (13) and Griffin (9) competed in their first walleye tournaments with me. As far as I know, there isn't a book with step-by-step instructions on how to train youth for competitive angling, but here are a few thoughts from my experience.

START IN THE GARAGE

We all know tournament prep starts with tackle prep. My boys have been helping organize tackle, paint jigs, re-spool reels, looking at maps, etc. They asked a lot of questions and I spent the time answering them. They wanted to help, so I found ways to involve them.

ON THE WATER

Nothing replaces on the water training. Taking them with me on pre-tournament practice days was a great way to help them learn what goes into preparing



Involving young people into the sport of competitive angling is a great way to spend quality time together on the water while teaching important life lessons.

for a tournament. Taking time to explain where we are fishing, tactics we are using, etc. helps build knowledge and interest. Both of them have been fishing on practice days for years.

BE A FAN FIRST

Both of them have been coming to tournaments, watching weigh-ins, listening to announcers, etc. for years. They learned a lot from watching and listening.

SET REASONABLE GOALS

Anderson's first tournament with me was a 100 boat local one-day tournament that had a family atmosphere. We had one day to practice together and devise a plan together. Despite catching incredible fish on our practice day, our goals were simple: Weigh a limit of five fish, be safe, and have fun! We caught 28 walleye and finished 39th out of 100 boats. Griffin joined us in a 50 boat tournament that allowed three anglers in the boat. Anderson fished with me in the adult division and Griffin

in the youth division. Again, our goals were simple; weigh a 5 fish limit, be safe, have fun! Our best 5 walleye counted in each of our respective divisions and despite losing some very nice fish and bringing only four fish to the scales, we finished in 17th place. Griffin said, "This was awesome dad!", as Anderson smiled at me and inside I felt as if we had won.

INVOLVE THEM IN DECISIONS

What color baits should we use? Should we make another trolling pass or change tactics? Should we switch to trolling crawlers instead of cranks and why? Don't just have them along for the ride. Take time to explain options, get their ideas, and make a decision together.

REMEMBER WHAT'S IMPORTANT

We all want to win the trophy, but in the end that isn't the most important thing. The memories you are making with your son or daughter, talking, laughing, celebrating catches and talking

about what went wrong are the moments that will last a lifetime.

Anderson ended up fishing the 350 boat Battle on Bago tournament with me as my normal partner was recovering from knee surgery. The final day of the tournament was on Father's Day. With 40 minutes to go we hooked onto our best fish of the two day tournament. It was barely hooked and he did a great job handling the drag and getting it to the net. When we got it in the boat and he saw the quality fish it was he said, "Let's Go!" and gave me a huge hug. The excitement he had at that moment was something I will never forget, nor will he. It was a special Father's Day.

Fishing tournaments with your son or daughter can be special and memorable too. Remember, spending time together on the water while catching fish will deepen that relationship with your son or daughter. That is the win and will be worth more than any trophy or monetary rewards in a tournament. Give it a try and remember to keep it simple; catch some fish, be safe and have fun!

THE OFF SHORE TACKLE MISSION STATEMENT

Our company's foundation is based on presenting products to the consumer that result in a more productive fishing experience. We strive to use the best available materials that are as eco friendly as possible. Our products are "Often Imitated but Never Duplicated". You can

buy cheaper products, but you can't buy better designed, built, longer lasting or more functional trolling products than those produced by Off Shore Tackle. That's why Off Shore Tackle LLC remains your "Leader in Trolling Technology."



A CRITICAL LOOK AT IN-LINE PLANER BOARDS

BY MARK ROMANACK

Historically, in-line planer boards have held what might best be described as a niche in the trolling world. These days, in-line boards have evolved a great deal. Designed to be affordable, easy to transport and store, in-line boards are also highly functional at spreading out trolling lines and covering massive amounts of water. In short, in-line boards do the heavy lifting these days and I don't mean maybe.

OR38 MINI BOARD

The OR38 Mini Board (aka Awesome Crappie Board) was designed with the tournament crappie anglers in mind. The perfect size for pulling a host of baits designed for crappie and other panfish species, the Mini Board may be small, but it performs like a much bigger board.

The ideal board for going after suspended crappie, with jigs, jig spinners, crankbaits and live bait rigs, the OR38 pairs up perfectly with traditional trolling rods or light action spinning tackle.

The OR38 also doubles as a walleye board when pulling spinner rigs or small crankbaits through weed flats. Small enough

to toss in a tackle box, but big enough to turn any rod into a trolling stick, the Mini Board is one of the most versatile side planers on the market.

Besides traditional trolling chores, the Mini Board is also handy for river anglers who fish from the bank. Simply cast a wobbling plug or spinner out into the current, clip the OR38 onto the line and let the board present baits to places it would be impossible to cast to.

OR12 SIDE PLANER

The OR12 Side Planer is the in-line board that all others are compared to. Originally designed for walleye trolling, the OR12 has evolved into a board that not only dominates the world of walleye trolling, but it is also comfortable targeting brown trout, lakere, steelhead, coho, chinook, kokanee and just about anything else that swims in fresh water!

The OR12 is capable of pulling crankbaits, live bait rigs, crankbaits with Snap Weights, Tadpole Divers, Mini Disks and even lead core line. "We use the OR12 Side Planer to pull just about every-

thing," says Jake Romanack of Fishing 411 TV. "Virtually everywhere we troll for walleye, the Side Planer gets the job done day in and day out. The same goes for trout and salmon trolling. Contrary to popular belief, the OR12 easily handles lead core set ups up to and including 10 colors of lead core!"

The OR12 comes factory standard equipped with the OR19 (orange) line release on the bracket and the OR16 (red) Pro Clip mounted to the tail of the board. This set up is ideal for anglers who troll using monofilament, co-polymer and fluorocarbon lines.

For anglers who prefer to troll with super braids, simply swapping out the OR19 for the OR18 Snapper Release or the OR39 Sam's Pro Release solves that problem. That's perhaps the biggest advantage of all Off Shore Tackle in-line boards. The releases and line clips can be swapped out to accommodate any line type or trolling technique.

The OR12 can also be retrofitted with an OR12TFEK Tattle Flag® HD Economy Kit. This kit uses the releases or line clips and flag that came on the board and converts the flag to a spring-loaded Tattle Flag® system. All the necessary linkage and hardware items come in this inexpensive kit. It takes only hand tools and about five minutes to convert an OR12 into a Tattle Flag® board.

Everyone who uses an OR12 with a Tattle Flag® HD Economy Kit immediately falls in love with this accessory. The flag will tip down indicating when a small fish has been hooked or debris fouled on the hooks. Infinitely adjustable, the Tattle Flag® works with everything from super light trolling gear to lead core and other heavy sinking lines. Holes on the flag and the nose of the board make it easy to adjust the spring tension as determined by the trolling methods and speed employed.

OR37 SST PRO MAG

The OR37 is the largest board in the Off Shore Tackle line up and designed for heavy duty trolling situations. The OR37 comes factory equipped with an OR18 Snapper Line Release on the bracket and an OR16 Pro Clip mounted to the tail of the board.

The SST Pro Mag is the board of choice for anglers who are trolling at high speeds or with heavy gear. Muskie anglers love the SST Pro Mag because it can handle the largest bucktail spinners, crankbaits as well as crankbaits fished in combination with in-line weights.

Trout and salmon anglers use the SST Pro Mag to pull long lengths of copper wire, lead core and weighted stainless-steel wire rigs.

Many catfish pursuers have success with the SST Pro Mag. With its added flotation and ability to pull the heaviest weights and baits it has become a popular choice among some of the best anglers in the country.

Saltwater trollers use the SST Pro Mag to troll big game gear at high speeds. Clearly the SST Pro Mag is the board of choice when targeting big fish and using heavy gear.

SUMMING IT UP

Off Shore Tackle produces the Mini Board, the Side Planer and the SST Pro Mag so no matter where you fish or what kind of fish you're targeting, there is an ideal in-line planer board for the job. All three board choices come out of the package ready to fish or if you prefer, each can be customized with the line releases or clips desired. Affordable, versatile and functional, it's no accident that Off Shore Tackle in-line boards have become popular everywhere avid anglers are serious about trolling.

YOUR LEADER IN TROLLING TECHNOLOGY

PLANER BOARDS
OR37, OR12, OR38

TATTLE FLAG® HD ECONOMY KIT
OR12TFEK
NOTE: The OR12TFEK only works with the OR12 Side Planer.

EZ CRANKBAIT TUNER
OR40
Adjustable tension knob prevents over-tuning

RELEASES AND CLIPS
OR1, OR2, OR8, OR18, OR19, OR16

TADPOLE DIVING WEIGHTS
OR36 Series

GUPPY WEIGHTS
OR20 Series

OFF SHORE TACKLE LLC
www.offshoretackle.com

YouTube Facebook Twitter

OFF SHORE TACKLE LLC
www.offshoretackle.com

LOOKING FOR SOMETHING

Maybe you missed some of our past editions of the “Off Shore Release”, or are need of more information on our products and their usage. All of this information is always available 24/7 on our website, www.offshoretackle.com!



GETTING STARTED FISHING GUPPY WEIGHTS

BY MARK ROMANACK

The beauty of the OR20 Pro Guppy Weights is they can be fished as in-line sinkers or Snap Weights. The unique design of the OR20 Guppy Weight functions perfectly as an in-line weight rigged a few feet ahead of a crawler harness, in-line spinner, crankbait or other lure.

IN-LINE RIGGING

In this set up the angler ties a snap to the end of his fishing line and attaches the snap to the top eye on the OR20 Guppy Weight. Next a 48 to 72 inch harness is attached to the tail of the OR20 Guppy Weight and the desired lure added at the terminal end.

Hooked fish are reeled in and netted without ever giving the OR20 Guppy Weight a second thought. Resetting that line is just as simple. Different overall lead lengths and different sizes of the OR20 Guppy Weights are used to target different depths.



The Off Shore Tackle OR20 Series Guppy Weight is a versatile trolling tool that can be rigged as a Snap Weight (pictured here) or as an in-line weight. One of the most effective and simple ways of getting all sorts of lures to depth, the Guppy Weight is at home trolling for everything from panfish to muskie.



SNAP WEIGHT RIGGING

The same OR20 Guppy can also be rigged using an OR16 Pro Clip and a split ring so the weight can be placed anywhere on the line. In this set up, the lure is deployed the desired distance behind the boat, then the OR16 rigged with an OR20 Guppy Weight is added to the line.

Simply pinch open the OR16 Pro Clip and place the line behind the plastic pin protruding through the center of the pinch pads. Once the line is behind the plastic pin and the clip closed, the Snap Weight is securely on the line. Running depth is controlled by the size of the attached Guppy Weight selected and by the overall lead length employed.

When a fish is hooked, the angler reels in the Snap Weight and quickly removes it from the line before reeling in the fish to net. When resetting this rig, simply let the lure back out to the desired distance, clip the Snap Weight on the line and deploy additional leader to dupli-

cate the rig that produced fish.

EMPLOYING IN-LINE BOARDS

Both in-line and Snap Weight versions of the Guppy Weights fish beautifully in combination with in-line boards such as the OR12 Side Planer. Boards help to spread out lines and cover more water.

When using in-line boards, rigs that are running higher in the water column should be positioned as the outside board lines. Deeper running rigs should be fished as inside board lines. This set up allows for a fish hooked on an outside board line to be reeled in without having to clear the inside board line.

MAST SYSTEM BOARDS

In-line weights and Snap Weights can also be fished effectively using a planer board mast system. In this case, all of the lines fished should be rigged with the same size weight and the same overall lead lengths.

Commonly anglers who prefer a planer board mast system will run a select size weight on one side of the board and a different size weight on the other side of the boat. This works to prevent tangles and helps to cover more water vertically and saturate the water column with lures.

SUMMING IT UP

One of the best ways to get started fishing in-line weights is to invest in the Off Shore Tackle OR20 Pro Weight System. This kit includes four OR16 Pro Clips, four split rings and an assortment of Guppy Weights in 1/2, 3/4, 1, 1.5, 2, and 3 ounce sizes. Everything an angler needs to get started is included in this kit. Both OR16 Pro Clips and OR20 Guppy Weights are sold separately, making it easy to add to the kit over time.

In-line weights are simple to use, versatile and effective at catching a wide variety of fish. Embracing the in-line weight is one of the easiest ways to put more fish in the boat.

OFF SHORE'S OR38 MINI BOARDS YIELD BIG RESULTS

BY ERICH CARLSON

Are you a seasoned angler, or just getting into the trolling game? The OR38 Mini Board is a fantastic tool that helps put more fish in the boat. Whether you fish for panfish, walleye, salmon or trout, there is an application for this little gem! This light weight, reversible, mini planer board performs amazingly well in many trolling applications where a larger board isn't necessary.

The OR38 Mini Board shines in many situations, such as in shallow water, when running short leads, trolling among the weeds, fishing in the presence of small panfish or off the bank of a river to position a bait for salmon or steelhead. The OR38 can even be trolled using a kayak! Aside from being versatile, what I enjoy most

about the OR38 is its ability to telegraph bites from the smallest panfish all the way to the biggest game fish.

The OR38 can be fished using conventional trolling setups, but many anglers opt to use spinning tackle! While targeting walleye in the weeds, I consider the OR38 to be a moving bobber/strike indicator. The OR38 makes it very easy to see if your bait is making contact with the weeds and also telegraphs when a fish has been hooked.

To put it simply, they are light, efficient, effective and a whole lot of fun to fish with! If you are looking to give yourself an edge, add a few OR38 Mini Boards to your fishing arsenal! You won't be disappointed.



Erich Carlson is a long time Off Shore Tackle pro staffer who spends a lot of time targeting walleye and other species with the OR38 Mini Board.

INTEREST IN THE "LOOP TRICK" CONTINUES TO GROW

BY MARK ROMANACK

As interest in in-line planer boards grows, so does interest among anglers in learning about the "loop trick". The "loop trick" is a rigging method that allows anglers to trip their planer boards, yet keep the board pegged in place on the line. Because the board is no longer planing to the side, reeling in a hooked fish or just reeling in a board to switch out baits becomes much easier. This unique rigging method also allows anglers to reel in fish without having to clear other board lines.

The good news about the "loop trick" is it doesn't require anglers to purchase any after-market products. The OR19 line release and OR16 Pro Clip that come standard on the OR12 Side Planer work perfectly with the "loop trick". The same is true for the OR10 release and OR16 Pro Clip that come on the OR38 Mini Board.

The "loop trick" requires using monofilament, co-polymer or fluorocarbon as the main line.

The "loop trick" doesn't work with low stretch and slippery super braids.

GETTING STARTED

Select a lure and let it out the desired distance from the boat. Now reach up and grab the line near the rod tip. With the line wrapped over an index finger, spin your finger to create a small loop of line with a few twists. Pinch open the OR19 (orange) release on the bracket of the board and place the twists of line between the rubber pads, leaving a loop of line about one-inch long protruding from the jaws of the OR19. The twists of line provide the OR19 plenty of purchase, eliminating any issues with false releases.

Once the line is secured to the OR19, pinch open the OR16 (red) Pro Clip at the tail of the board and position the line behind the plastic pin protruding through the middle of the rubber pads. When the line is placed behind the plastic pin, the OR16

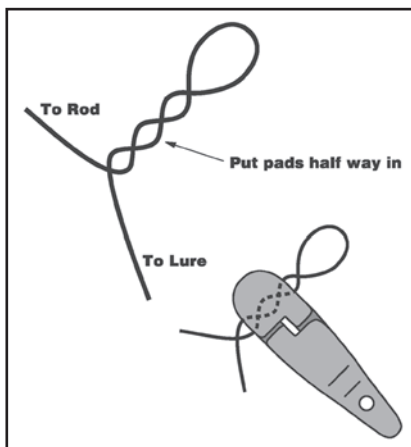

will hold the line securely and when the line is tripped from the bracket, the board will remain pegged in place thanks to the OR16.

SETTING LINES

Drop the board in the water and play out line, allowing the board to work its way out to the side of the boat. Stagger lead lengths with other board lines so the shortest leads are positioned on the outside board lines and longer leads become the inside board lines. Rigged in this fashion it's possible to stack three, four, five or more lines on each side of the boat.

TRIPPING THE BOARD

When a board hooks a fish and starts sagging from the weight of the hooked fish, simply grab that rod from the rod holders and give the rod tip a swift upwards snap, to trip the line free from the release on the bracket. The loop of line used in attaching the release on the bracket of the board to the line makes it easy to release the board. Meanwhile, the OR16 keeps the board pegged in place on the line.

Releasing the board to fight a fish eliminates the need to fight the resistance of the board as it continues to plane. More importantly, it allows the angler to feel every head shake of the hooked fish, making the fight more enjoyable. Also, because the board is no longer planing, the fish doesn't have a solid wall in which to pull against. When the fish runs, the reel drag can slip and the rod works nicely to

**CONTINUED ON
PAGE 6**

OFF SHORE TACKLE PODCAST



The man behind the voice of the monthly Off Shore Podcasts, Mike Avery, incorporates all the knowledge he passes along to his listeners when he gets the chance to hit the water.

Thanks to long time pro staffer Mike Avery, Off Shore Tackle hosts a monthly Podcast. The Off Shore Tackle Podcast got started back in May of 2015. Each of these podcasts are available on the www.offshoretackle.com web page. Simply log onto the home page and click the podcast tab to listen free of charge.

Each podcast features a different Off Shore Tackle pro staffer discussing fishing topics that are near and dear to their hearts. The topics include but are not limited to crappie, catfish,

walleye, trout, salmon, muskie and even striper fishing.

Over the years a ton of excellent fishing information has been shared on the Off Shore Tackle podcast. If you have any suggestions about topics or who you would like to hear from, drop us a line and let us know at offshoretacklehelp@gmail.com.

Please note that some products have changed or been discontinued over the years. Also, the articles and podcasts authored by pro staffers represent their own opinions and views.

THE OR12TFEK TATTLE FLAG® HD ECONOMY KIT

BY MARK ROMANACK

Many years ago, Off Shore Tackle was the first to offer their customers an articulating, spring loaded flag system for detecting light bites. Dubbed the Tattle Flag®, this aftermarket item makes it possible to add a spring and linkage arm to the OR12 Side Planer to convert the standard factory supplied flag to a Tattle Flag® system.

The OR12 Side Planer doesn't come standard with the Tattle Flag® setup, but it can be easily added thanks to the OR12TFEK Tattle Flag® HD Economy Kit, available at most Off Shore Tackle dealers. The OR12TFEK kit contains a heavy duty linkage arm, spring, washer and the necessary hardware to convert any OR12 into a Tattle Flag® board.

The Tattle Flag® HD Economy Kit doesn't include a flag or release/clip as these come standard on the OR12 Side Planer to begin with. Installing the Tattle Flag® kit only requires basic hand tools and about five minutes time. If you have questions, the Instructions Sheet page on the www.offshoretackle.com web page offers a detailed PDF file aimed at helping customers install the upgrade.

Once installed, the spring tension on the Tattle Flag® can be adjusted by placing the spring in different holes provided on the flag stem as well as on the nose of the board. The many holes provided make it possible to rig a Tattle Flag® for trolling literally any lure big or small and at all common trolling speeds.



The OR12TFEK Tattle Flag® HD Economy Kits from Off Shore Tackle provide the linkage arm, spring and hardware needed to convert an OR12 Side Planer into a Tattle Flag® board.

Tattle Flag's® are commonly used when fishing live bait rigs, but this useful planer board accessory works great no matter what kind of lures are being trolled or what species is be-

ing targeted. The OR12TFEK Tattle Flag® HD Economy Kits help save money and help our customers catch more fish. It doesn't get much better than that!



YouTube™



Detailed assembly instructions available on our website at www.offshoretackle.com

You must have an OR12 Side Planer and the release/clip that came with the OR12 in order to use this **Economy Kit** for converting your OR12 to a Tattle Flag® HD Board as they are NOT supplied with this item. **Without these items, IT WILL NOT WORK.**

There must be slack between the release/clip on the planer board bracket and the red OR16 attached by split ring to the Tattle Flag® HD wire as shown below.



Note: Use the orange OR19 on the bracket if you want the OR12 to trip or you can use a red OR16 on the bracket if you want the OR12 to stay set.

WILL LIVE SONAR ELIMINATE PULLING BOARDS FOR CRAPPIE?

BY DAN DANNENMUELLER

Live sonar has certainly changed the face of tournament crappie fishing. However, when the biggest fish matter, one has to ask if other techniques such as pulling are being replaced. Personally, I believe any technique in any given weather, water, or moon condition can be the go-to method.

Statistics show that when live sonar is used correctly during tournaments, it will consistently outperform any other technique to catch the biggest 5 to 7 crappie within a given time period. However, less than one percent of the fishing population participates in tournaments. Most of us are more interested in catching the legal limits of wonderful-tasting crappie.

Even though I will utilize live scope during many tournaments, I don't solely rely on it. Sue and I have used other techniques when pre-fishing tournaments and on fishing trips.

In June of 2023, we were fishing a tournament on Sardis Lake in Mississippi. We located a big school of fish just outside the major upper timber lines. These were post-spawn crappie, and they were feeding on schools of shad. At times, they were stationary on the bottom but fed several times during the



Forward facing sonar has come into play during crappie tournaments in recent years; however, techniques such as “pullin” using long lines or in-line planer boards will continue to be the most popular with the masses.

day by suspending around the shad balls.

We chose to pull crankbaits and jigs on Off Shore Tackle OR12 Side Planer Boards with #1 OR36 Series Tadpoles. On day 1 of the tournament, we caught 87 crappies with 1.72 pounds as our biggest, and on day 2 we caught 64. It was a lot of fun and were culling both days for our best five to weigh in.

What makes other alternatives such as pulling Off Shore Boards productive is the ability to cover a lot of water efficiently, effectively, and quickly. If the crappie are suspended away from trees, brush piles, etc.

pulling boards can be very rewarding. Exploring areas using the boards by varying baits and depths helps to eliminate locations where there aren't fish, as well as select the proper actions, colors, and depths over larger areas for active crappie.

If you are fishing bigger lakes and rivers with wide expanses of water, I like pulling/running the boards as far as 150 to 200 feet. I have found that running 4 boards on each side of the boat this far out tiered to the boat at varying intervals will cover a LOT of water. Horizontal approaches like this allow for the element of surprise without prop noise, electronic signals, etc.

The crappie are not as spooky.

For smaller waters or when you want to saturate the areas you are fishing with each pull or pass, I like to reduce the amount of line out each side and the interval distance. This may be necessary when the fish are more scattered. The optimal distance between boards for me is 20 to 25 feet. This allows for turns with fewer line tangles.

Pulling with Off Shore Planer Boards can be more enjoyable, as fishing with live sonar can be a very focused technique. Concentrating on a screen while casting or pitching to a fish periodically means you are doing it alone with very little intake from what is around you. Pulling allows for several trollers to enjoy a day on the water with engagement between each other and the surroundings.

The type of boat used really doesn't matter as you can pull boards from a kayak, pontoon boat, aluminum boat, or even a bass boat. It will require a good trolling motor, depth finder, rod holders, rods and reels, Off Shore Planer Boards, OR36 Series Tadpoles (optional), a trolling app like Precision Trolling Data, and baits. Live sonar and related electronics are not necessary and can reduce investment costs substantially.

INTEREST IN THE “LOOP TRICK” CONTINUES TO GROW

CONTINUED FROM
PAGE 4

tire the fish.

The ability to fight fish without having to clear other lines is yet another bonus of the “loop trick” rigging method. Those who try this rigging method are quickly convinced it's easy to do and a much more enjoyable way to fight fish than the old-fashioned method of reeling in the board as it is planing.

BRAID TRICKS

Anglers who want to fish braided lines can still rig their

boards to release. Doing so requires investing in the OR39 Sam's Pro Release and mounting this unique release on the bracket of the board. At the tail of the board the OR16 Pro Clip can be used or substituted for the OR18 Snapper.

The Sam's Pro Release functions by wrapping the line around a rubber plunger that is in turn placed in a tension adjustable jettison. When a fish is hooked, snapping the rod tip pops open the rubber plunger from the jettison and allows the braided line to unravel. Mean-

while the OR16 Pro Clip or OR18 Snapper keeps the board secured to the line.

LOST FISH

Some anglers mistakenly claim that releasing boards puts slack in the line and leads to losing fish. This may have been true of old-fashioned release and slide rigging methods, but not with the “loop trick”. Because the board remains pegged in place on the line, snapping the rod tip trips the line from the bracket, stopping the board from planing. In the same instant the line comes

tight on the struggling fish.

The end result is that the “loop trick” doesn't allow slack in the line or the fish a chance to escape. Steady tension is held on the fish from the instant it bites, until the time it hits the landing net.

SUMMING IT UP

The “loop trick” works flawlessly and it also can be used with board accessories such as the OR12TFEK Tattle Flag® kits. The only anglers who are not sold on the “loop trick” are those who haven't tried it.

COLOR CODING SNAP WEIGHTS FOR QUICK SETS

BY ROY MILLER

One thing I hate when fishing crawler harnesses is making a move and having the diving device get tangled or banging around on my trolling rods. When tournament fishing, every step needs to be accomplished as quickly as possible. Spending time untangling in-line weights isn't an option.

To become more efficient, I started painting my own Snap Weights to create a color code I can use when pulling crawler harnesses. Using color coded Snap Weights provides a few advantages.

First, it allows me to remove the weight when making another pass or heading in for the day. Second, removing the Snap Weight causes less stress on

the equipment and less tangles especially in rough water that's common on the Great Lakes. Third, I can switch weight sizes quickly when trying to stay tight to structure and weed lines that may be at different depths in the same pass.

I prefer to keep my lead lengths as short as possible for less chances of something going wrong. Different weights allow me to get to my target depths while keeping lead lengths the same or as close to the same as possible.

Color coding my own weights allows me to find the size I need at a glance. I feel it speeds up my sets and eliminates errors when grabbing Snap Weights. Powder paints hold up well on Guppy



Roy Miller suggests color coding Guppy Weights on his Snap Weight set ups to make it easier to identify sizes at a glance.

Weights, but spray paint or permanent markers are also a good option.

Editor's Note: Roy Miller is the owner of Fat Boy Jigs and an avid tournament angler who uses Off Shore Tackle products often.



DON'T BE FOOLED

We are "Often Imitated, Never Duplicated". Make sure that when you purchase your products that they are Original Off Shore Tackle products that have proven to be successful and dependable! We take pride in bringing you the BEST quality!

INSTRUCTION SHEETS ARE HERE TO HELP

BY MARK ROMANACK

If you have ever had a question about an Off Shore Tackle product, that question can be answered by one of dozens of "Instructions Sheets" offered on the www.offshoretackle.com web page.

Each "Instruction Sheet" is offered in an easy to open and easy to print PDF format. In addition to written instructions, detailed drawings make it easy to understand every aspect of Off Shore Tackle products.

To find these Instruction Sheets simply log onto www.offshoretackle.com and on the landing page check out the menu of items on the left hand side of the page. About two-thirds down the page you'll see

the menu "Instruction Sheets". Click on this menu and dozens of PDF files will pop up for your learning experience.

On the same menu a little further down the page you'll see the heading "Questions & Answers" another useful link on our website for learning more about Off Shore Tackle products.

The next time you're contemplating asking a question about Off Shore Tackle products on an internet "chat site", do yourself a favor and get the information you need from the horse's mouth. No one knows Off Shore Tackle products better than their employees and trusted pro staff members.

REPLACING WORN LINE RELEASE AND CLIP PADS

BY LEE GOULD

One thing that drives people to the sport of fishing is the simple fact that anyone can do it and there is an abundance of water available to do it in. People from all walks of life, income level, or social class can get out and fish somewhere and that helps make it such a universally popular sport and pass time.

After heavy use, the pads can become worn and as a result, I was replacing the line releases and clips on my Off Shore Tackle planer boards. What I have started doing is instead replacing the rubber pads in the releases and clips. This is a very easy and very inexpensive way to get another year out of them.

Replacing your pads is really a quick and easy process. I've played around over the years on how best to replace the rubber pads on Off Shore Tackle line releases. I use either a small hobby vise or a Quick Grip wood clamp to hold the clip open. This step is not necessary when replacing the pads on the OR18 Snapper Release.

Next thing is getting a small flat blade screwdriver and start peeling and lifting that pad from the jaw. The pads are glued but usually once it starts coming up it goes easily. Use your screwdriver to clean around the pocket where the rubber pad sits on both the top and bottom jaws. After the old rubber pad is removed, I grab a new rubber pad with a pair of tweezers and put a small dab of super

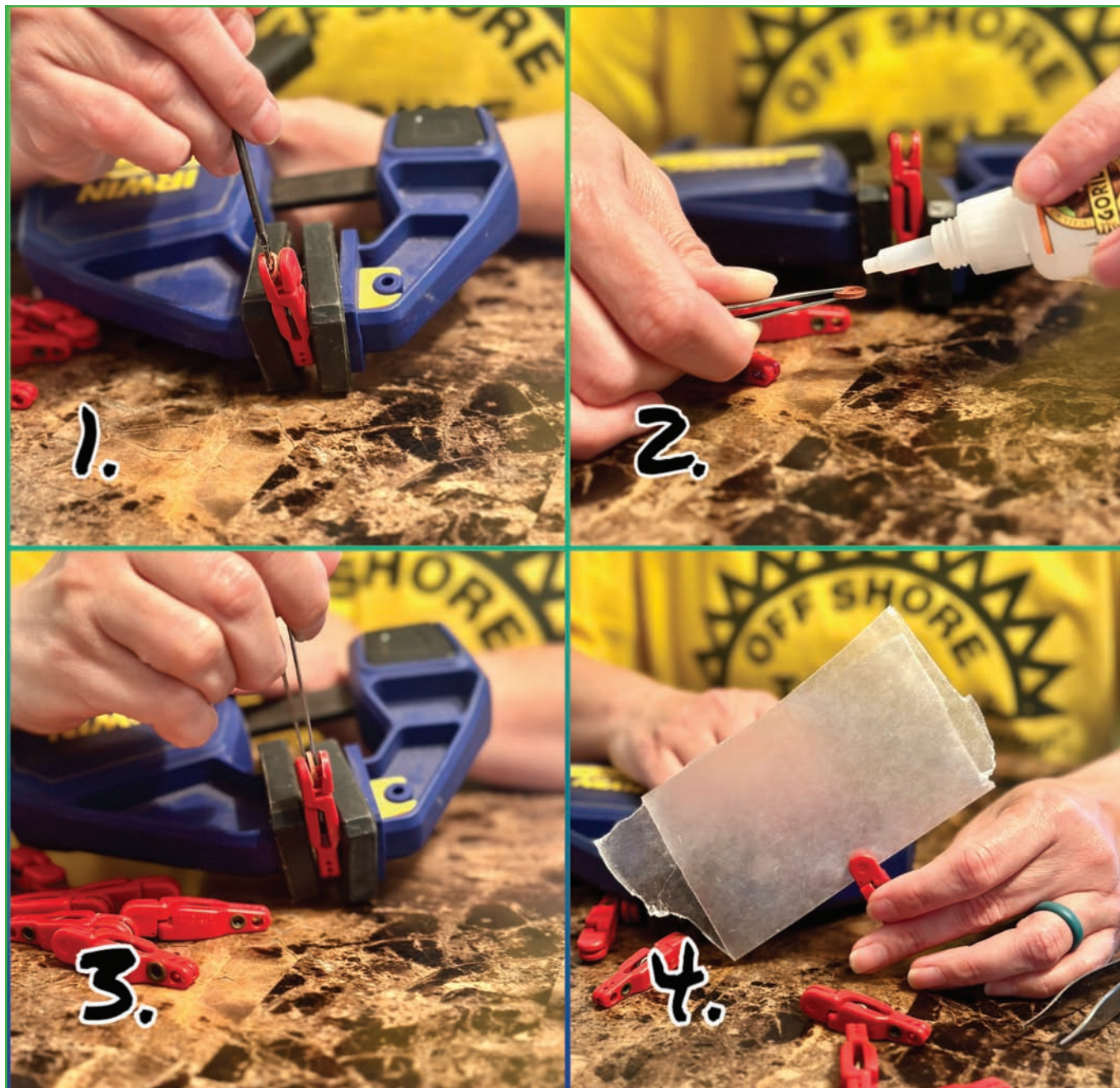

glue on the pad and then lay the new pad in place. I prefer the gel type super glue because it's less likely to run and make a mess.

After the pads are installed, I usually clip them on to a piece of

wax paper to be sure I didn't get too much glue on the pads. Replacing the rubber pads on my line releases and clips only takes a few minutes of my time and replacement pads are sold in packs of 8 to 16. They are

available online under Replacement Parts, or at most of your favorite Off Shore Tackle Dealers! It's an easy way to freshen up your boards every year and save some money in the process!

OFF SHORE TACKLE REPAIR KITS AND LOCAL PRODUCT SUPPORT

BY ROB BARNES

Off Shore Tackle is known as "Your Leader In Trolling Technology". To this end we also strive to be a leader in customer service. Did you know that we have pro staff members across the U.S. and Canada who are issued repair kits for the purpose of supporting our customers in their local areas?

The purpose of these repair kits is to restore planer boards and trolling product to a serviceable condition. Repair parts such as hardware, brackets, foam, and ballast weights are often on hand in these kits.

Please note that wear items such as releases, clips, pads and springs are not stocked in these kits and we encourage you to purchase these through your local retailer or our website.

Off Shore Tackle pro staff are experts in the use of our trolling products and producing the most performance out of planer boards and releases. Our staff often bring these kits to seminars, local fishing club meetings, and events in order to assist Off Shore Tackle product owners in their area.

Here are a few of our staff members issued repair kits to assist you by region:

Ohio:

- Julia Davis
- Randy Gaines
- Zak Jobs
- Darrell Wood
- Mike Knippenberg
- Nicholas Zart

Wisconsin:

- Ken Doepker
- Corey Hanson
- Barb Carey- WI Women Who Fish

Michigan:

- Jim Brant- Western Michigan / West Michigan Walleye Club
- Erich Carlson- Northern Michigan / Thunder Bay Walleye Club
- Rob Barnes- Southeast Michigan/ Lake St. Clair Walleye Association

Ontario:

- Greg Horoky
- Ed Mackenzie
- Shane Turcotte

A LETTER FROM THE CHAIRMAN OF THE BOARDS, BRUCE DESHANO

Another year has gone by and as always, a lot of changes. America got back to work and we got caught up with our product deliveries thanks to the staff at Off Shore. Without their hard work, it would not have been possible. They do not get enough credit for what they do.

I did not fish much as the bay was too windy for me. Fishing

was good when I did get out. Nick and I had a few good wall-eye days. I always enjoy seeing the boards go back! I fished the OR38 Mini Board's quite a bit pulling crankbaits and they really bounce around when a good fish eats the bait. We drug out the old Hot 'N Tots just for fun and they catch walleye as good as any of the newer baits! I also fished with

Mike Martin earlier and we went in the canals casting for bass and found a nice school of crappie which I pulled a nice 14 1/4" one good for a Michigan Master Angler Patch along with a large white bass later trolling for another patch! That was fun too!

Nick has been taking care of business and that leaves me with a lot of time to travel. Nick,

Renee, Ari, Jenna and I all went to Alaska for 2 weeks and saw whales, brown bear with cubs and a lot of eagles. We flew over the glaciers and were amazed at the size of them. Traveling is on my schedule for 2024 and hoping for less wind and more fishing.

Thanks for all your support and keeping Off Shore Tackle "The Leader In Trolling Technology".



It's always great to get 3 generations of DeShano's on the boat with Nick, Ari, and Bruce.

NEW DIGITAL FORMAT OF THE OFF SHORE RELEASE! FROM THE DESK OF NICK DESHANO

Hard to believe this is the 31st edition of the Off Shore Release! Since its inception, millions of copies have made it to the hands of anglers across the globe. Much has changed over the years, but one thing has remained the same; the Off Shore Release remains one of the most popular publications in the fishing world!

In addition to the hard copy, the Off Shore Release can be

found in a downloadable PDF format on our website. Simply go to the web page www.offshoretackle.com and when the home page loads, click on the "Articles" tab. All of the "Release" newspapers since 1999 are available free of charge to read and enjoy. Literally hundreds of articles written by Off Shore Tackle pro staffers are featured.

Starting with the 2024 edition,

the Off Shore Release is available at <https://offshorerelase.com/>. It is a clean, easy way to navigate site that contains all the information included in the Off Shore Release and more, such as video tips and other useful links

to help you catch more fish! As always, our goal of the Off Shore Release is information oriented publication, not a sales catalog. If there is a topic you'd like to see discussed in future editions, please email me at offshoretacklehelp@gmail.com.



SCAN FOR DIGITAL VERSION OF THE OFF SHORE RELEASE



OFF SHORE TACKLE Your Leader In

Our products can be used with any monofilament

Planer Boards

Model # OR38 Awesome Crappie Mini Board



Each OR38 Awesome Crappie Mini Board includes an OR10 release, OR16 Pro Clip, black bracket, split ring, lock nut, 6/32 x 1/2" screw, and instructions. One board... Dual Purpose...It's Reversible and runs directly off of your rod line! Ideal for several species of fish not just crappie. Don't let the size fool you.

Model # OR12L Side Planer Left
Model # OR12R Side Planer Right



Each OR12 Side Planer includes a stationary flag, one OR19 release, one OR16 Pro Clip, instructions and is carefully ballasted to run flawlessly in rough water off of your rod line. Ideal for several species of fish.

Model # OR37L SST Pro Mag Planer Left
Model # OR37R SST Pro Mag Planer Right



The SST Pro Mag Planer includes a stationary flag, one OR18 release with lock nut, one OR16 Pro Clip, instructions and is designed to carry large, heavy baits further to the side than any other in line planer! Perfect for long copper and lead core lines. The OR16 Pro Clip on the tail of the board ensures that your board will stay on your fishing line.

Tattle Flag® HD Upgrade Kit

Model# OR12TFEK
Tattle Flag® HD Economy Kit



This kit works by using your OR12 Side Planer with the flag and release/clip that came on your OR12. This kit just contains ONLY the hardware which consists of a HD wire, spring, washer, screw eye, split ring, 6/32 screw and limited instructions.

Planer Board Releases

Our three full size planer board releases come with a quick clip for use on dual planer boards. Also available without quick clips. Their large diameter pinch pad design holds monofilament lines securely. Tensions can be adjusted further by how deeply the line is placed in the pads.

Model # OR3
Light Tension Planer Board Release - White



This release is ideal for small light biting fish.

Model # OR17BWW
Medium Tension Planer Board Release - Black



This release is ideal for deep water good size fish. It can also be used to pull lead core, snap weights and deep diving crankbaits.

Model # OR30BWW
Heavy Tension Planer Board Release - Red



This release is ideal for large lures and high speed trolling.

Model # OR18 Snapper Adjustable Tension
In Line Planer Board Release—Black

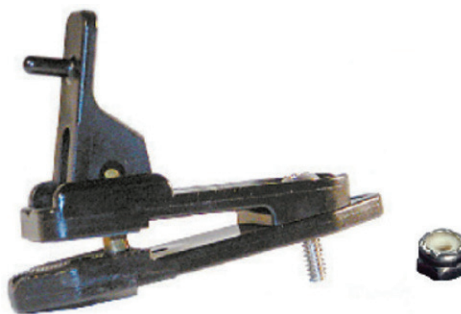

The OR18 is designed with an adjustable cam action locking arm that can be set to release at a range of tension settings or tightened down to hold even super braid lines and lead core securely. This release comes standard on our OR37 SST Pro Mag Planer and is made to attach to the bracket of our OR12 Side Planer as well.

Model # OR39
Sam's Pro Release-Black



Manufactured by Silver Horde, the OR39 Sam's Pro Release incorporates a jettison design that allows low stretch super lines to be wrapped around a rubber plunger that in turn fits into a pressure fit housing. This release is good for all species that the super lines are ideal for.

Our three mini size adjustable tension planer board releases come with quick clips for use on dual planer boards and split rings for use on in-line planer boards. They are also available without quick clips and split rings. Tension can be further adjusted by simply sliding the spring toward the pads to increase tension or away from the pads to decrease tension.

Model # OR10
Adjustable Light Tension
Planer Board Release—Yellow



This release is ideal for small light biting fish.

Model # OR14
Adjustable Medium Tension
Planer Board Release—Black



This release is ideal for deep water and/or good size fish as well as most commonly used for rigging add-a-lines or fixed slider lines among downrigger anglers.

Model # OR19
Adjustable Heavy Tension
Planer Board Release—Orange



This release comes as standard equipment on the OR12 Side Planer and is ideal for large lures, high speed trolling

The red OR16 Pro Clip is found under the Pro Weight section on page 11.

PRODUCT SHOWCASE Trolling Technology



line, for best results we suggest a minimum of 10 lb. test.

Pro Weights



Model # OR20
Pro Weight System



Each system includes instructions, four OR16 Pro Clips, four split rings, two of each of the following guppy weights: 1/2 oz., 3/4 oz., 1 oz., 1 1/2 oz., 2 oz., and 3 oz. all contained in a plastic tackle box. Use as Snap Weights or In Line Weights - you decide. This system is used off of flat lines, dual planer boards and side planer boards.

The OR16's and guppy weights are available to purchase separately so you can create your own custom Pro Weight System!

Model # OR16
Pro Clip—Red



This mini size clip has an extra heavy spring tension and includes a split ring. You simply position your fishing line behind the pin that protrudes through the center of the pads to hold your snap weight securely on the line.

The OR16 comes as standard equipment on the tail of the OR37 SST Pro Mag Planer, OR12 Side Planer, OR38 Awesome Crappie Mini Board and in our OR20 Pro Weight System. It is ideal for use with snap weight fishing, super braid lines and with our OR12TFEK Tattle Flag® HD Upgrade Kit system.



Replacement Pro Guppy Weights

- Model # OR20 1/2
1/2 Ounce Pro Guppy Weight
- Model # OR20 3/4
3/4 Ounce Pro Guppy Weight
- Model # OR20 1
1 Ounce Pro Guppy Weight
- Model # OR20 1 1/2
1 1/2 Ounce Pro Guppy Weight
- Model # OR20 2
2 Ounce Pro Guppy Weight
- Model # OR20 3
3 Ounce Pro Guppy Weight

These items, replacement parts, and promotional items (including apparel) are all available through our website. PLEASE VISIT US AT ...

www.offshoretackle.com

★ SHOP ANYTIME ON-LINE ... CONVENIENT & SECURE ★

Resettable Diving Weights



Model # OR36 1
Tadpole Size 1

Model # OR36 2
Tadpole Size 2

Model # OR36 3
Tadpole Size 3

Model # OR36 MAGNUM
Tadpole MAGNUM Size

Downrigger Releases

Our downrigger releases are all full size and therefore have the large diameter pinch pad design that holds monofilament lines securely. Tension can be adjusted further by how deeply the line is placed into the pads.

Model # OR4
Light Tension Single
Downrigger Release, White



This release is ideal for light biting fish.

Model # OR1
Medium Tension Single
Downrigger Release, Black



This release is ideal for deep water and/or good size fish.

Model # OR8
Heavy Tension Single
Downrigger Release, Red

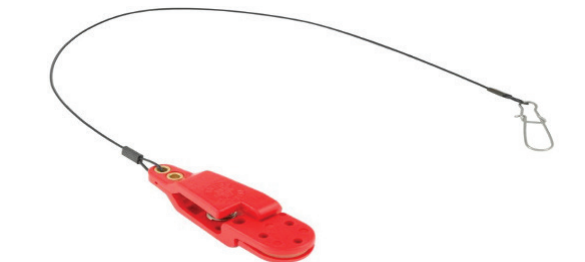

This release is ideal for large lures and high speed trolling.

Model # OR7
Light Tension Stacker
Downrigger Release, White



This release is ideal for small light biting fish and allows you to run two lines off of the same downrigger.

Model # OR2
Medium Tension Stacker
Downrigger Release, Black



This release is ideal for deep water and/or good size fish and allows you to run two lines off of the same downrigger.

Stacker Stripper/Weight Retriever

Model # OR6
Stacker Stripper/Weight Retriever

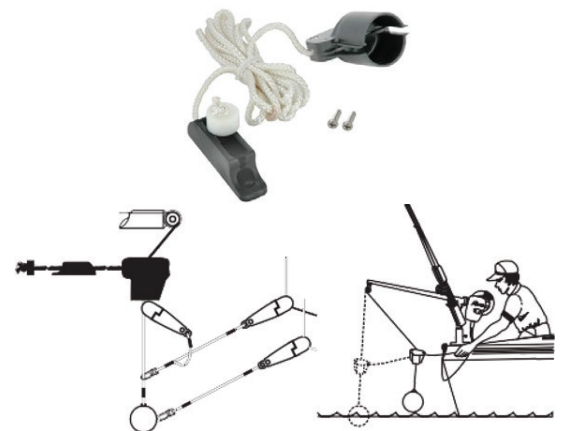





Stacking two lures on a downrigger is quicker and easier with the OR6 Stacker Stripper.

As the weight is raised, the Stripper will automatically strip the stacker release from the cable so you won't have to stop the cannonball. The automatic stripping eliminates the grooves worn into stacker pads from sliding on the cable.

The OR6 doubles as a Weight Retriever to bring the weight into the boat for resetting lines. Using the retriever cord will reduce damaging cannonball sway.

Replacement Pads

-  Model # ORRP8
Replacement pads for OR1, OR2, OR3, OR4, OR7, OR8, OR17, and OR30 releases.
-  Model # ORRP8SN
Replacement pads for OR18 releases.
-  Model # ORRP16
Replacement pads for OR10, OR14, and OR19 releases.
-  Model # ORRP16HL
Replacement pads for OR16 clips.

EZ Crankbait Tuner

Model # OR40
EZ Crankbait Tuner



These unique tuning pliers feature a long and short jaw design that includes an adjustable spring tension setting making it possible to tune any crankbait.

PLANER BOARD LINE RELEASES, THE TOOLS OF THE TRADE FOR PLANER BOARD MAST FISHING

BY MARK ROMANACK

The planer board mast system is a fish harvesting system. In the hands of anglers who understand how to get the most from a planer board mast system, fish hardly have a chance!

RELEASES MATTER

Any captain or hard core troller who owns and uses a planer board mast system will tell you, the key to making this trolling system work smoothly is using the right line releases for the job. Off Shore Tackle is the industry leading supplier of line releases designed for fishing with a planer board mast system. From light tension releases ideal for small to medium sized fish, up to and including extra heavy releases for muskie and saltwater trolling applications, Off Shore Tackle has the perfect line release for the job.

MINI SIZE RELEASES

OR10 LIGHT TENSION LINE RELEASE

The OR10 (yellow) is the lightest tension line release in the Off Shore Tackle line up. Designed for targeting smaller fish, the light tension of this popular release is perfect for walleye, spring coho, pink salmon and other smaller game fish species.

OR14 MEDIUM TENSION LINE RELEASE

The OR14 (black) line release features a slightly stiffer spring tension than the OR10 and is commonly used by anglers who troll at faster speeds or use larger lures when targeting walleye, coho, pink salmon and other small to medium sized game fish.

FULL SIZE RELEASES

OR3 LIGHT TENSION LINE RELEASE

The OR3 (white) is an all-purpose line release that features larger jaws and rubber pads than the OR10 or OR14 releases. The extra surface area of the rubber pads makes this release ideal for those who troll at faster speeds or those who troll using deep diving crankbaits.

Designed with walleye trolling in mind, the OR3 also works very well for spring coho and brown trout fishing applications.

OR17BWW MEDIUM TENSION LINE RELEASE

The OR17BWW (black) is the perfect line release for targeting larger fish such as lake trout, steelhead and chinook salmon. The heavier spring tension and larger pad diameter is ideal for



Off Shore Tackle produces a host of planer board line releases for using with planer board mast systems including the OR3, OR10, OR14, OR17, OR19 and OR30.

anglers who are trolling at faster speeds and using larger lures.

OR30BWW HEAVY TENSION LINE RELEASE

The OR30BWW is a heavy tension line release ideal for targeting muskie and saltwater trolling applications. The extra tension of this release is perfect for trolling big baits and also at high speeds.

SUMMING IT UP

When it comes to line releases different trolling applications call for different line releases with different tension settings. That's why Off Shore Tackle produces so many different line releases aimed at serious anglers who prefer to troll using a planer board mast system.

ABOUT THE EDITOR

Veteran outdoor writer, Mark Romanack, is the editor for the annual Off Shore Tackle Release newspaper. One of Off Shore Tackle's earliest pro staff members, Mark is uniquely equipped for the task of making sure this annual newspaper helps anglers to be more successful on the water.

Mark started his career as a part time outdoor writer and part time tournament fisherman. His passion for fishing and communication skills soon led Mark to take on outdoor communications as a full time career.

In 2007 Mark took the plunge into outdoor television as the host and executive producer of the Fishing 411 TV series that



broadcasts on Sportsman Channel, World Fishing Network and Sportsman Canada. Fishing 411

TV is currently filming season 18, one of the longest running television series featured on

Outdoor Sportsman Group.

Mark is also the founder and co-owner of the Precision Trolling Data phone apps. Many Off Shore Tackle products including Tadpole Divers and Guppy Weights are featured in this popular trolling app that helps anglers literally aim their trolling gear to specific depths.

Individuals interested in submitting articles or photographs for future editions of the Off Shore Release are welcome to reach out directly to Mark via e-mail at Mark@Fishing411.net. Creative articles and quality photos that focus on using Off Shore Tackle products receive the highest priority.

WHY I DON'T RELEASE BOARDS

BY CAPTAIN LANCE VALENTINE

One of the most asked questions on my charters and at seminars is “Do you release your Off Shore boards”? While I have tried different release methods, currently I do not release my boards. Here’s my thoughts on why.

My normal spread when trolling open water is 6 to 7 Off Shore Tackle OR12 boards and one corner down rod on each side. I’m almost always fishing with anglers who have little trolling experience, especially with that many rods in the water. By keeping my boards attached, they are helping me; pulling away from the boat, keeping tension on the line and the fish and most important to me, staying in their location in the spread. All these factors allow me to get everything in the boat ready to land a fish. We fish hundreds of hours every year and can honestly count the number of issues we have on one hand. Below are the most common questions I get and my answer.

How do you bring in the outside board to change a lure without getting tangled?

This is probably the only hard thing about not releasing, but I have a pretty good system. First, I turn the boat AWAY from the board I want to bring in.

Second, I grab the rod and move to the back of the boat on the OPPOSITE side and “pull” the rod tip as far as I can to the side. Third, I reel in about 30 feet of line, then free spool the board back about 30 feet. This move slides the board closer to the boat. I simply repeat until the board is in clear to reel in.

How do you reset a board into its original position?

Again, simple. I let the lure out, attach the board then free spool the board down the “chute”, the open area directly behind the boat. When the board has reached the proper amount of line out from the board to the rod, I simply engage the reel and the board swoops right back into place. A little tip: I am VERY detailed with how far from the rod tip each board is.

How do you bring in a fish without releasing boards or clearing lines?

In my mind this comes down to two important things: rod holder position/setup and setting lures in your spread. First, a big mistake I see anglers make when rigging for trolling is spacing rod holders along the gunnel. When doing this, boards closer to the boat will run further back from the gunnel than boards



further out. This is due to the position of the rod tip being further back on inside boards and creates a situation that makes it harder to get outside lines over inside lines. By moving all the rod tips forward and on the same vertical plane (think rod trees), the “pull point” for each board is the same, meaning boards closer to the boat will run further forward than outside boards, eliminating the need to clear boards. Your boards should run in distinct “V” pattern, getting further behind the boat the further to the side they are.

Second, paying attention to WHERE lures are in your spread will eliminate most tangles. When fishing unweighted crankbaits, always set the LONGEST LEADS to the outside

with shorter leads closer to the boat. Remember, when fishing unweighted cranks most of the line is on, or near, the surface. By setting shorter leads on the inside, outside boards can be brought in without ever catching the line from the inside rods. When fishing any type of weight or diver, set the SHALLOWEST lures to the outside and deepest inside.

To release or not? A question all trollers need to answer, and always a topic of intense discussion! I hope that for those that prefer to not trip their boards this provides some insight on what has worked best for me after many years of fishing and thousands of hours pulling Off Shore boards.

WHAT'S IN YOUR BOAT?

BY COREY HANSON

Being prepared and ready to fish is easy when you have Off Shore Tackle products in your boat. My “go to” trolling board is the OR12 set up with the OR12TEFK Tattle Flag® HD Economy Upgrade Kit and the OR18 Snapper Release. For me, this set up makes it quick and easy to get the board off the line when I’m reeling in a fish. I typically run three lines per side of the boat and stagger my leads to reach different depths. I prefer to run my deepest lure on the outside board line and progressively shallower lures on the middle and inside board lines.

I also like to run different lure colors to start with and keep track of what board gets hit and

what color lure is producing best. After a few fish you can see a clear pattern emerging.

If I find fish are super shallow, I’ll switch over to lighter line, smaller lures and the OR38 Awesome Crappie Board (aka Mini Board). I consider the OR38 my secret weapon because these boards are stealthy and ideal for fishing spooky fish. Despite the name, the Awesome Crappie Board isn’t just useful for catching crappie.

Ever wonder why some crankbaits catch fish and others not so much? Crankbaits produce best when they run straight and true in the water, but not all crankbaits run properly straight out of the package. Learning how to

tune crankbaits by making small adjustments to the “pull point” of the lure is an important fishing skill.

Begin by pulling a bait with a few feet of line out to determine if the lure is running straight or if the lure is running left or perhaps right of center. If the bait is running left of center or right of center, the pull point on the lure must be bent slightly in the opposite direction to make a correction. This a trial and error process that requires making an adjustment to the pull point and then checking the bait again. Sometimes it takes several adjustments to eventually get the pull point properly adjusted and the bait running straight and true.

This process is known as “tuning” a crankbait. Most anglers use a pair of needle nose pliers for this process, but the OR40 EZ Crankbait Tuner is a better tool for the job. The slip-jaw design and adjustable tension setting of the OR40 makes it possible to achieve very small, precise and repeatable adjustments to the crankbait pull point. The OR40 EZ Crankbait Tuner works on small crappie and panfish baits, all the way up to magnum muskie and saltwater lures.

No matter your favorite species of fish, Off Shore Tackle has you covered with quality products designed to help you catch more and bigger fish.

TUNING CRANKBAITS 101

BY MARK ROMANACK

Every crankbait should come out of the package tuned and ready to fish. While modern crankbaits are far more likely to be tuned in the package than their predecessors, at some point every crankbait is going to need a tune up.

The biggest culprit for why crankbaits routinely get out of tune can be traced to baits that have actually been catching fish. A fish struggling in the net can put considerable force on a crankbait. Just as damaging, twisting and or jerking aggressively to remove a hook from the fish's mouth can bend the pull point of the lure.

The pull point is the place the line attaches to the crankbait.

Bending this small wire loop even minutely will cause a lure that is running straight in the water to run left or right of center.

A crankbait that is out of tune will not run straight in the water. When this occurs, the bait is not achieving its natural diving depth or providing it's designed action. In short, a bait that was working just fine can easily get knocked out of tune and suddenly that bait goes cold from a fish catching perspective.

Thankfully, with a few minutes attention, any crankbait can be hand tuned to run perfectly again. The process of tuning a crankbait is a trial and error event. The process of tuning a bait involves casting the bait and retrieving it or dragging the bait out to the side of the boat. The idea is to observe the bait to see if it is pulling straight in the water or flaring to the left or right of center. If the bait is running left of center, bending the pull point wire slightly to the right can correct this situation. The reverse is true for baits running to the right side of center.

The keys to tuning a crankbait involve making very small adjustments to the pull point. A little goes a long way and beginners tend to bend the pull point too much causing a bait that may have been running right of center to suddenly start running left of center.

Bending the pull point and then checking to see how the adjustment impacted on the bait is the trial and error process involved in tuning a crankbait. At times a crankbait can be tricky to tune. This often happens after a bait has been tuned many times and the wire pull point starts to become soft from repeated bending. This is precisely why it's important to make very small



adjustments to the wire pull point. Bending the pull point too aggressively or too often can permanently damage the crankbait beyond repair.

While hard use is usually the reason a crankbait is out of tune, it's common for a bait to come out of the package running left or right of center. This occurs because the wire pull point was not perfectly aligned in the mold when the crankbait was cast.

Thankfully correcting this situation is a simple matter of tweaking the pull point wire and checking the results. It usually takes two or three adjustments to tune a crankbait to run straight, but sometimes a bait can take a lot more effort to achieve a satisfactory tune. Certain brands of lures are notorious for being difficult to tune. This is a quality control issue that can be traced back to the way the bait was manufactured in the first place. Attention to detail is critical in making sure the pull point wire is mounted precisely in the right location when the lure is molded.

Some baits are so hard to tune, many anglers simply avoid fishing them! No one wants to spend their whole day tuning lures that should be running true out of the package in the first place.

TUNING WHILE TROLLING

Most trollers are going to tune their lures while they are on the water fishing. A bait can be tuned while trolling, but there are a few things to be cautious about. Avoid trying to tune a crankbait by letting the bait straight out the back of the boat. As the boat moves it displaces water creating a kind of back eddy directly behind the boat. This disturbed water doesn't

provide a clean and steady flow of water flowing past the bait, making it very tricky to see if the lure is precisely tuned or not.

Instead, consider moving to the front of the boat and pull the crankbait along side the boat where the water has not been as dramatically displaced. Sweeping the rod tip forward will speed up the bait and showcase if the lure is running left or right of center or diving perfectly straight in the water.

CASTING TO TUNE

A good argument can be made that the best way to tune a crankbait is casting the bait while the boat is sitting still or drifting. Cast the bait a short distance, point the rod tip at the bait and lower the rod tip to the water surface. Now reel the bait back as fast as possible. A fast retrieve will showcase any imperfections in how well the bait is tuned, making it easy to see if the bait is running right or left of center.

Make the necessary adjustment to the pull point and then make another cast to repeat the process. Usually two or three casts is all it takes to get the bait running perfectly straight in the water. This is how we tune crankbaits for Precision Trolling Data testing because it guarantees that every bait we test will be hyper tuned and running to perfection.

ENTER THE OR40 EZ CRANKBAIT TUNER

In the past, anglers have tuned their crankbaits with a pair of needle nose pliers. The biggest drawbacks of using needle nose pliers are that you can scratch up the bill of the bait and it is very easy to over tune, which can damage

the pull point and ruin the bait. A better alternative is to use a device designed especially for tuning crankbaits, the OR40 EZ Crankbait Tuner produced by Off Shore Tackle. The OR40 is an enhanced pair of pliers with one jaw longer than the other. One jaw is placed on the pull point of the lure and the other jaw rested against the edge of the lure's diving lip.

A slip clutch mechanism is built into the pliers so precise amounts of pressure can be applied to the pull point of the lure time and time again. This pressure is controlled by tightening or loosening a spring built into the tuner. By setting just enough pressure to make a change in the bait it is much more difficult to over tune the bait. The EZ Crankbait Tuner is made out of a high strength plastic that will not damage the bill.

Once the EZ Crankbait Tuner is adjusted properly, baits can be tuned very quickly because each adjustment applies exactly the same amount of pressure to the pull point. Slick. If you haven't tried the OR40 EZ Crankbait Tuner it's worth taking a serious look at.

SUMMING IT UP

A properly tuned crankbait will catch more fish than one that is not running straight and true in the water.

Tuning a crankbait can be time consuming and tedious, but it's a necessary skill for anyone who casts or trolls using diving crankbaits. Taking the time to mastering the skill of tuning crankbaits is the first step in becoming a master at catching fish on these hard baits.

STACKING DOWNRIGGERS FOR HEAVY TRAFFIC AREAS

BY JAMIE ROBINSON

Great Lakes trout and salmon fishing hot spots in both the spring and fall often end up being river mouths. These areas tend to be heavily fished and running multiple rod setups can be tricky considering all the boat traffic.

It's not uncommon for 50 to 100 boats to all be fishing within a mile or less of critical water. For this reason, running lead core line, Off Shore Tackle planer boards or even diving planers can be problematic. However, a viable option is to

run downriggers using short to moderate leads behind the downrigger balls. When fishing traffic, I run most leads in the 30 foot range but never more than 50 feet behind the downrigger ball.

My downrigger setup consists of two downriggers and in an effort to add more than two rods to my spread I incorporate Off Shore Tackle's OR2 Medium Tension Stacker Downrigger Releases. The OR2 allows me to run two rods per downrigger, effectively doubling the number

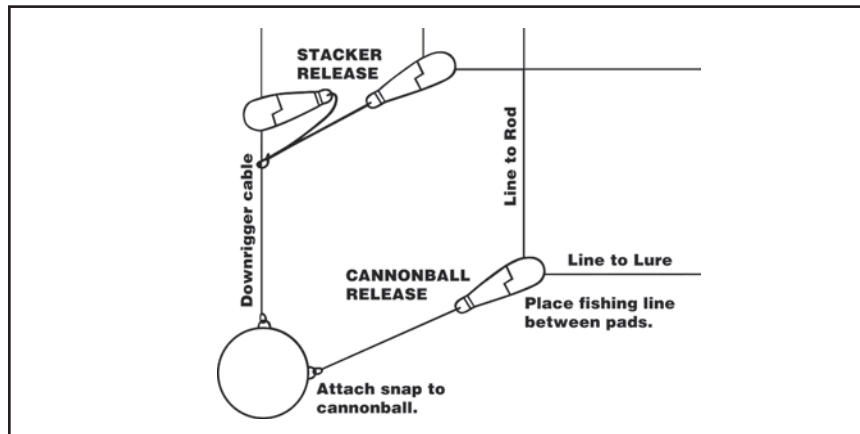

Jamie Robinson is an Off Shore Tackle pro staffer from Wawa, Ontario who targets salmon and trout often on Lake Superior. Using OST stacker releases, Jamie doubles down on his trolling success.

of baits in the strike zone.

I have found the OR2 Medium Tension Downrigger Stacker Release to be a versatile trolling accessory that helps me troll for both light biting fish and still run larger tackle items such as magnum spoons, deep diving crankbaits or my favorite flashers such as Yakima Bait Company's Fish Flash. To rig this setup, the first step is to set your main line or the line that you will attach to the downrigger ball. One thing to note is the main line will need to have a longer lead length than the rod you plan to run off the OR2 to avoid tangles.

I like to have the main line leader length at least 10 feet longer than the stacker rod's lead length. Also, I like to run 15 to 20 feet between the main line and the stacker line to avoid a fish hooked on the main line from potentially tangling in the stacker line.

Now that the main line is at the desired length behind the downrigger ball and clipped to the release lower the ball 15 to 20 feet down and now attach the OR2 Stacker Release to the downrigger cable by clipping the snap to the cable and then the stacker release's short cable release to the downrigger cable above the snap. The stacker release's long cable with release is where you will attach the second rod/line.

Once this is hooked up you will lower the ball to the desired depth and the stacker line will be running whatever depth

above the ball you set it at. Off Shore Tackle's website has instruction sheets for all their products and for a good illustration of this setup see the OR2 instruction sheet.

The trout and salmon I target are usually in 70 to 150 feet of water with prime depths to fish generally being in the 40 to 70 foot range. A good example of how I start out the day is with one downrigger running 70 feet down with the stacker rod running at 50 feet. While the second downrigger would have the mainline down 60 feet with the stacker rod running 40 feet down.

My preference is to run the two downriggers' depths no closer than a 10 foot difference, but if the fish are at a very specific depth, I will run them as close as 5 feet apart. However, keep in mind that the closer downrigger lines are run to one another, the greater the risk of tangles.

The OR2 Medium Tension Downrigger Stacker Release not only allows me to double down on my fishing success, it helps me fish in high traffic areas without the stress of worrying about those other boats.

EDITOR'S NOTE: Jamie Robinson is a highly successful tournament angler, Off Shore Tackle pro staffer and avid angler who resides in Wawa, Ontario and frequently targets trout, salmon and steelhead in the Ontario waters of Lake Superior.

PLEASE NOTE

Before using any fishing/rigging method, make sure to consult your local Department of Natural Resources fishing directory to confirm local fishing regulations.

OR16 PRO CLIPS AND FISHING WITH FRIENDS

BY ROB JONES

Over the years I've introduced a lot of friends to fishing with the Off Shore Tackle OR12 Side Planer. I set my boards up using an OR19 (orange) release on the bracket and an OR16 (red) Pro Clip at the tail of the board. I prefer this rigging method as it allows me to trip the board when a fish is hooked, yet still keep the board pegged in place on the line while fighting the fish. The catch is that to accomplish this goal the line has to be placed behind the pin protruding through the center of the OR16. If the line isn't placed behind the pin, the board can pop off the line and simply float away!

The way to avoid chasing boards all day when fishing with new anglers is to take some time at the beginning of the day to show your fishing buddies exactly how to use the OR16. Pinch open the OR16 and be careful to place the line behind the plastic pin that is protruding through the rubber pads before closing the OR16.

Hooked up correctly on the OR16 the board is not going to come off the line, your day will be spent fishing, having a good

time and not chasing boards. It's just that simple.

RIGGING DIVING PLANERS WITH THE OR16

Great Lakes waters have become clearer over the years. I've started fishing diving planers like the popular Dipsy Diver with much longer leaders than traditionally employed by rigging an OR16 Pro Clip to the release arm and also the swivel at the back of the diver. I use the split ring that comes standard with the OR16 to make these connections.

When setting up, I use a rod that has been rigged with a 25 to 50 foot length of fluorocarbon leader material that is double uni-knotted to a braid backing line. I let the lure I'm fishing out until the braid backing is at the rod tip. Now I'll snap the trip arm closed on the diver and select the desired planing setting by rotating the counterbalance weight mounted to the back of the diver. The next step is to place the leader material near the braid backing behind the pin in the OR16 on both the front and back of the diver.

With the diver attached to the line in two places, thanks to the OR16 Pro Clips, I place the diver in the water and slowly play out line by engaging the bait clicker on my line counter reels and backing off on the drag tension of the reel so that line slowly clicks off the spool. When the desired lead length is reached, I tighten the drag on the reel back down enough that the diver doesn't continue to pull out additional line.

When a fish strikes, a sharp snap of the rod tip will pop the trip arm mechanism open, stopping the diver from continuing to dive. Meanwhile leaving the diver pegged in place on the line makes it easy to fight the fish.

When the diver is close enough to the rod to reach, simply pinch open the two OR16 Pro Clips and remove the diver before fighting the fish to net. This simple rigging method is similar to using Snap Weights and makes it possible to create space between my lures and the diving planer. This diver rigging method works in all water conditions but is especially stealthy when fishing in clear water.

Once you've tried fishing a Dipsy rigged this way, you'll never go back to attaching the leader to the back of the diver again.

USING THE OR30 TO HOLD THE NET BAG

When targeting big fish like muskie, the landing net also needs to be big. A landing net with a large bag can easily get snagged on rod holders, boat cleats and other items at the moment of truth. An easy way to avoid this problem is to use an OR30 Heavy Tension Line Release to hold the net bag tight against the net handle.

I rig this up by adding a split ring and oversized snap swivel to the OR30. The OR30 is then secured through the snap swivel to the net handle using a wire tie positioned on the net handle so when the bag is laid flat, the OR30 can easily be clipped lightly to the net mesh.

When netting a fish, the net bag stays up against the net handle until the weight of the fish hitting the bag pulls the net bag free and allows the fish to drop into the scoop. Slick.

For smaller fish like walleye, trout and salmon, the lighter tension OR17 can be used in a similar way.

SUMMING IT UP

Off Shore Tackle produces some of my favorite and most frequently used trolling products. You can't beat Off Shore quality and innovation. Just another reason why Off Shore Tackle is "Your Leader in Trolling Technology".

Editor's Note: Rob Jones is an Off Shore Tackle pro staffer, based out of Ontario, Canada who fishes Off Shore Tackle products often and for a host of species.



Rob Jones is an Off Shore Tackle pro staffer from Ontario Canada who trolls often on Lake Erie and Lake St. Clair.

DISCLAIMER

Product features, opinions, and/or individual's contact information may have changed since these articles were originally composed.

TROLLING SHOWS TO LOOK FORWARD TO

Off Shore Tackle is the title sponsor for the Fishing 411 TV series hosted by Mark and Jake Romanack. Each year Fishing 411 TV produces 13 original full length television episodes that can be seen on the Sportsman Channel, World Fishing Network and Sportsman Canada outdoor television networks. Fishing 411 TV is also available on MyOutdoorTV.com, Outdoor America and the Fishing 411 TV YouTube Channel.

Off Shore Tackle products are featured in several of the 2024 line up of television shows produced by Fishing 411 TV. These same shows will also be featured on the Fishing 411 TV YouTube channel after they broadcast on national television. Don't miss a single episode.

TORCH LAKE ATLANTIC SALMON

Beautiful Torch Lake in northern Michigan is one of the few land-locked atlantic salmon fisheries in North America. Back in 2010 the world record atlantic salmon was caught in Torch Lake. Currently, Torch Lake is



teaming with 18-22 inch class atlantic salmon and the fast track to catching these elusive fish is trolling spoons using lead core line deployed using Off Shore Tackle OR12 Side Planers.

LONG POINT MIXED BAG

Long Point situated on the Ontario side of Lake Erie is home to one of the most OVER-LOOKED mixed bag fisheries in the Great Lakes. It's here during the summer months that anglers

are routinely treated to steelhead, walleye and even the occasional coho salmon! Catching these fish involves using spoons and a mixture of lead core line deployed on Side Planers, diving planers rigged using OR16 Pro Clips and downriggers rigged with OR8 Heavy Tension Downrigger Releases.

PRECISE WALLEYE CRANK WALLEYE

The new Precise Walleye Crank

designed by Mark and Jake Romanack is rapidly becoming a "must have" crankbait for Lake Erie anglers. Designed to have that critical "rolling" action at slow speeds, matching these baits up with Snap Weights and OR12 Side Planers is a recipe for success.

NIAGARA RIVER MOUTH TROUT AND SALMON

When trout and salmon invade the mouth of the Niagara River in Lake Ontario, the stage is set for some of the most exciting fishing of the year. Using their walleye rods/reels, Mark and Jake put the smack down on trophy lake trout and chinook salmon trolling the Mag Lip 3.0 and 3.5 plugs using Snap Weights to achieve greater depths and the OR12 Side Planer boards to cover the maximum amount of water.

LAKE ONTARIO TROUT AND SALMON

Lake Ontario consistently produces some of the most dependable salmon fishing in the Great Lakes. During the month of May, the famed "Niagara Bar" attracts boat loads of salmon and catching them is about deploying spoons on lead core line using Off Shore boards to spread out lines and also using the OR8 Heavy Tension Downrigger Release to fish rotating plugs with 11 inch Pro Troll paddles.

PRESQUE ISLE LAKE TROUT

The tiny port of Presque Isle, in Northern Lake Huron may well be the most consistently excellent lake trout fishery in the Great Lakes. Trolling an eight inch Pro Troll paddles with a No. 2 sized Spin-n-Glo is money when it comes to catching these fish. Downriggers are critical and the OR8 Heavy Tension Downrigger Release is the perfect choice for targeting lakereels in deep water.

SUMMING IT UP

Every year Fishing 411 TV visits some of the hottest and most unique sport fisheries in North America. The focus of every show is education and helping other anglers cash in on the amazing fishing opportunities found all across this great land.

OR20 PRO WEIGHT SYSTEM
SNAP WEIGHT RIGGING INSTRUCTIONS

THE 50/50 METHOD
Walleye, steelhead, trout or salmon suspended within 20' of the surface are prime targets for the 50/50 rigging method.

Set your favorite spoon, spinner or shallow diving crankbait 50-feet behind the boat. Pinch an OR16 Snap Weight Clip onto the line and let out an additional 50-feet of monofilament. This lure and snap weight combination can be fished as a flat line or rigged on an Off Shore Tackle Side Planer or Riviera catamaran style dual (DPB) or triple (TPB) planer board.

When using the 50/50 rigging method, it's best to start fishing with several different weights until the fish communicate which weight and depth range are most productive.

Begin fishing each day with a lure spread that incorporates a variety of snap weight sizes. Staggering lures at different depths is the fastest way to pattern suspended fish. Once a pattern has been determined, switch all lines over to duplicate the productive weight and distance combination.

OFF SHORE TACKLE

www.offshoretackle.com

OR20 PRO WEIGHT SYSTEM
IN LINE WEIGHT RIGGING INSTRUCTIONS

THE IN LINE METHOD
Attach the Guppy Weight as shown on the left.

Once you locate fish, use a Guppy Weight heavy enough to place your rig or bait about a foot or so above the fish you see on sonar. For multiple lines, let out a different distance or use a different weight to let the fish determine the proper combination. Planer boards work very well with in line weights when fish are shallow. When fish are near the surface, the line behind the planer board can be very short. Eight to ten feet is often enough. Once you find the right combination, use it on the rest of your lines.

OFF SHORE TACKLE

www.offshoretackle.com

VERSATILITY IS THE KEY TO TROLLING SUCCESS

BY JEFF NUECHTERLEIN

One of the many things I enjoy about my Off Shore Tackle planer boards, is the many accessories available to outfit my boards. The springs, screws, nuts and wire on the Tattle Flag® systems are all made of quality stainless steel. Nothing will ever rust on an Off Shore Tackle planer board.

I also appreciate that Off Shore Tackle offers several options to secure your fishing line to the board. There are times I prefer my board to remain secured to both the front and back clip, such as when I'm targeting walleye. For walleye trolling I prefer to use the OR18 Snapper Release up front on the bracket and the OR16 Pro Clip mounted to the tail of the board.

Other times, especially when trolling for salmon and trout, I prefer to release the board. This is when I rig up to use the OR39 Sam's Pro Release mounted on the bracket of the board and the OR16 on the tail of the board. Rigged this way I can trip the board when a fish is hooked, so I'm not struggling to fight the board and a powerful fish at the same time. Releasing the board reduces the chances a big fish will pull the board under water, increasing the odds of landing powerful fish like trout and salmon.

You can't go wrong with an Off Shore Tackle planer board. Rig them however you like and get your troll on!



Off Shore Tackle produces the most versatile in-line boards and trolling releases on the market which greatly aided in Joe Ryba catching his nice walleye!

MOST POPULAR RIGGING OPTIONS FOR YOUR OR12 SIDE PLANER

As with all rigging options, once you set up your OR12 the way you want, attach the board to your 10-12 pound test monofilament fishing line through the release located on the bracket and BEHIND the center pin of the OR16 on the tail of the board. Let the board out the side of the boat to the desired distance you want the board to run.

Once the fish is hooked, the weight of the fish will cause the board to sag or be pulled backwards in the water. You then simply reel the OR12 into the boat and quickly remove it from the line, letting you fight the fish without the board attached. You can also "trip" your board when a fish is on or if you want to change baits, with a quick snap of the rod toward the engine and the board will stop planing and move out of the spread towards the back of the boat. By tripping the OR12 in this manner, it allows you to bring an outside board in without getting tangled with the inside boards. When the OR12 is tripped, the line is pulled out of the OR19 release that is on the bracket while the OR16 on the tail of the board will keep the board attached to the line and keep it from sliding down to the fish (**DO NOT LET THE BOARD SLIDE DOWN TO THE FISH AS THIS CAN CAUSE YOU TO LOSE THE FISH**). Slowly reel in the board until it is within reach, remove the board from the line and continue to fight the fish to the net.

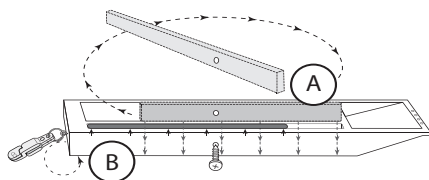
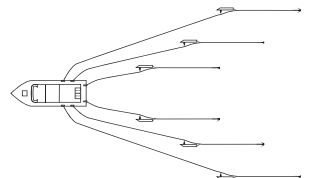

Lead Core and Copper Rigging

The OR12 is great for pulling heavy weights such as 7 or more colors of lead core and long copper lines over 200'. There are a couple simple adjustments that you can do to make them pull even better. To make the board run more "nose down" and get a better bite of the water to get it further out to the side, reposition the weight to the front of the weight chamber by rotating the weight (A). The rear OR16 clip can also be repositioned to the lower hole at the front tail of the board (B). **BY RIGGING THE BOARD THIS WAY, IT WILL PULL FARTHER AHEAD, BUT IT WILL ALSO HAVE A HIGHER TENDENCY TO DIVE WITH LIGHTER WEIGHTS - YOU MAY NEED TO PUT THE WEIGHT BACK TO ITS ORIGINAL POSITION WHEN SWITCHING BACK TO LIGHTER BAITS.**

Super Line Rigging

When using Super Lines, due to their thin diameter and slick surface, they can slip through and damage the pads of the conventional releases. We recommend the OR18 Snapper Release (sold separately) for use with modern super lines and can replace the OR19 with no modifications needed. With the lever in the forward position on the OR18, it prevents the board from coming off the line via a pin in the front of the release (C). If you prefer, simply snap the lever in the back position, and the release will allow the board to trip and slide back (D). It is also important to "wrap" the line in the rear OR16 clip when using super lines to keep the line from slipping through the pad (E). (*Slipping line can damage the pad as well as the pin in the center of the pad.*)

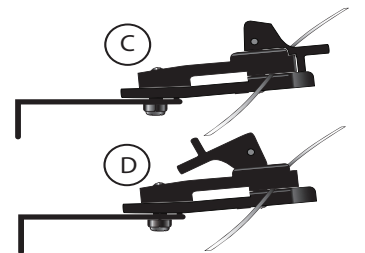
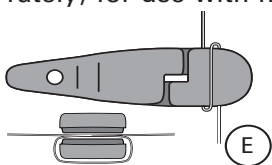

Tattle Flag® Rigging

In order to convert your OR12 to a Tattle Flag® board, you will need to purchase an OR12TFEK Tattle Flag® Economy Kit (sold separately). We have incorporated extra holes in the stem of the flag to accommodate even more settings for detecting light biting and small fish for those of you that choose to convert your OR12 to a Tattle Flag® board.

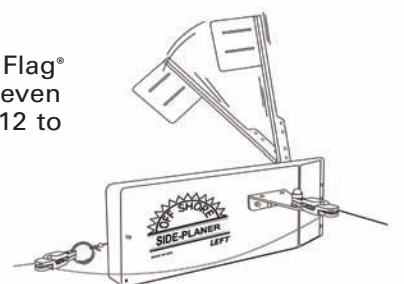

MANY MORE DETAILS, GREAT TIPS AND TECHNIQUES CAN BE FOUND 24/7 ON OUR WEBSITE WWW.OFFSHORETACKLE.COM AS WELL AS OUR YOUTUBE PAGE.

THE VERSATILE OR16 PRO CLIP

BY MARK ROMANACK

Off Shore Tackle produces so many line releases and clips it's hard to know them all. Arguably the most versatile of these products is the OR16 (red) Pro Clip.

SNAP WEIGHTS STARTED IT ALL

The OR16 Pro Clip was designed to hold an in-line trolling weight, secured by way of a split ring, originally made of lead and acquired the name of Snap Weight, allows you to place the Snap Weight on the line at any desired location. This unique line clip features rubber pads similar to other Off Shore Tackle line releases but molded into the middle of the pads is a small plastic pin. When the OR16 is pinched open and the line placed behind this pin that protrudes through the center of the pads, the Snap Weight is securely held in place on the line.

This unique, yet simple design makes it possible to troll using

in-line weights and place those weights anywhere on the line. To say the least, when the OR16 Pro Clip hit the market they were an immediate success. Prior to this product, no other manufacturer had produced an in-line weight that could be put on and taken off the line in a "snap"!

The OR20 Pro Weight Kit soon hit the market offering angler four OR16 Pro Clips and an assortment of in-line weights ranging from .5 ounces to 3 ounces in size. Eventually the lead weights were replaced with more ecological friendly Guppy Weights which are molded from non-toxic zinc alloy.

Guppy Weights were designed to be used as either a Snap Weight in combination with the OR16 Pro Clip or as a traditional in-line weight. The OR16 was designed with Snap Weight fishing in mind, but it didn't take long for this line clip to find other important trolling niches.

OR12 SIDE PLANER

It didn't take long and the OR16 became widely used on the OR12 Side Planer. Many anglers mounted the OR16 on both the bracket and at the tail of the board to insure the OR12 would stay on the line no matter how big the waves or how fast the trolling speed.

These days the OR16 comes standard on the OR12 Side Planer. Routinely mounted at the tail of the board, the OR16 teams up with the OR19 (orange) release makes it possible to trip the board, yet keep the board pegged in place on the line thanks to the OR16. This rigging method has become one of the most popular ways of fishing the OR12 Side Planer for walleye, trout, salmon, steelhead and other species.

OR38 MINI BOARD

The OR16 clip is also factory supplied with the OR38 Awesome Crappie Board (aka Mini

Board). This small in-line board was designed for trolling small lures on light line. Ideal for targeting crappie and other smaller fish species, the OR38 can be released, yet remain pegged in place on the line thanks to the OR16 mounted at the tail of the board.

SOLD IN TWO PACKS

The OR16 Pro Clip is so popular, Off Shore Tackle also sells these clips in a handy two pack. Replacement pads are also sold separately. The OR16 isn't just a run of the mill line clip. It's the line clip that started a generation of anglers using Snap Weights and also in-line planer boards. Versatile? You can say that again, because the OR16 is hands down the most commonly used line clip for trolling applications all over the world.

THE OR20 PRO GUPPY WEIGHT AND THE 50 + 2 DATA SYSTEM

BY JAKE ROMANACK

What do you do when you're marking lots of fish, but your crankbaits just don't dive deep enough to reach those fish? This common problem is easily solved with the help of an in-line trolling sinker known as the OR20 Pro Guppy Weight. Available in 1/2, 3/4, 1, 1.5, 2, and 3 ounce versions, the Pro Guppy Weight is designed to be attached to the OR16 Pro Clip by split ring making the setup a Snap Weight that makes it easy to add weight to the line and also to get crankbaits to deeper depths.

The Precision Trolling Data 50+2 Data System is a popular trolling option that matches up the 2 ounce Snap Weight with a host of popular crankbaits. The 50+2 system allows anglers to get crankbaits to deeper depths, to achieve those depths using shorter overall lead lengths and also to target very specific depth

zones in the water column.

To get started using the 50+2 system consult the Precision Trolling Data phone app. The PTD app is available for both Android and iPhone smart phones and features a "lists" function that makes it easy to determine which crankbait brands and models feature the 50+2 data. Currently, the majority of the popular crankbait brands and lure models feature this unique data.

Once you've picked a crankbait, touch the "line type" option and select the 50+2 Snap Weight option. Now let the desired bait out behind the boat 50 feet and attach a 2 ounce Snap Weight to the line by pinching open the OR16 and placing the line behind the plastic pin. The next step is to consult the PTD app and select the trolling speeds desired from the "MPH" picker wheel. Next select the

desired target depth from the "feet down" picker wheel. The PTD app will then calculate the total overall lead length required in the "feet back" picker wheel. The app includes the initial 50 foot lead into the total overall lead length required to reach the selected target depth. It's that simple!

Thanks to the 2 ounce Snap Weight, crankbaits can be fished much deeper and on shorter lead lengths. Even better this system can be trolled out to the side of the boat using an OR12 Side Planer making it possible to fish multiple lines and lures at multiple depths.

Pick your lures, pick your trolling speed and pick your target depth, the PTD app and the 50+2 data is just that easy to use. Every year new lures are added to the 50+2 data system as the PTD app is updated.

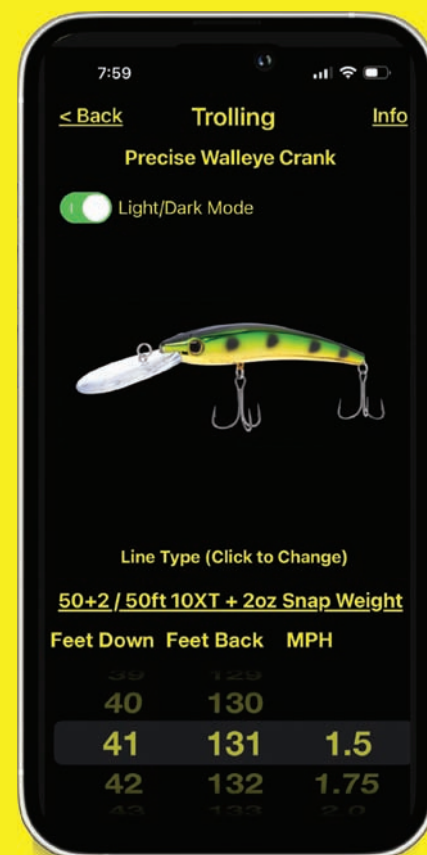

The Precision Trolling Data phone app features unique Snap Weight trolling data for a host of popular crankbaits. This information is called the 50+2 Data and appears in the app under the "Line Type" option. Using Snap Weights to get crankbaits to deeper depths is a wildly popular trolling technique for walleye, trout, salmon and many other species.