

**FREE!**



Volume 24, 2017



Chairman of the Boards BRUCE DESHANO  
Vice Chairman of the Boards NICK DESHANO  
Editor MARK ROMANACK

# The **OFF SHORE** RELEASE

Your Leader In Trolling Technology [www.offshoretackle.com](http://www.offshoretackle.com)



Printed by Stafford Printing



Nick DeShano prefishing for the Crappie Masters National Championship on Granada Lake in Mississippi.

**Tips and Techniques brought to you by  
Your Leaders In Trolling Technology,  
Off Shore Tackle LLC and Riviera Trolling Systems**

# THE OR12 SIDE PLANER, THE MORE THE MERRIER

BY MARK ROMANACK

Most avid anglers understand that fishing with an in line board like the famous Off Shore Tackle OR12 Side Planer helps them catch more fish. Spreading out lines indeed helps cover more water and contacts more fish.

Anglers who believe the adage if “one is good, two is better” are going to want to read on. In the game of trolling the amount of fish an angler can catch is directly in relationship to how many lines that angler is fishing. More lines really do add up to more fish and with the OR12 these boards come factory equipped with the right releases designed to allow anglers the option of stacking two, three, four or more boards per side!

### FACTORY RIGGING

The OR12 comes factory rigged with an orange OR19 Heavy Tension Planer Board Release mounted to the bracket and a red OR16 Pro Snap Weight Clip mounted to the tail of the board. The Pro Snap Weight Clip is unique in that between the rubber pinch pads is a small plastic pin. When the clip is opened, the line placed behind the pin and the clip closed, the line is firmly held in place and can’t “release” from the clip.

The OR12 comes factory equipped this way so anglers can stack several boards per side of the boat, release those boards when a fish strikes and most importantly reel in those hooked fish without having to clear any other fishing lines.

Here’s how the system works. Set your desired bait behind the boat, pick up the OR12 and open the orange OR19 release. Place the fishing line near the back of the rubber pads and let the OR19 close on the fishing line. Next take the fishing line in one hand and the red OR16 Pro Snap Weight Clip in the other hand. Open the OR16 and place the line behind the plastic pin.

The Side Planer is now attached to the fishing line in two locations. The OR19 functions as a line release and the OR16 functions as a line clip. Rigged in this manner drop the board in the water and let line play off the reel while trolling. The OR12 will plane nicely out to the side of the boat.

Once one board is set, repeat the process and set two, three, four or more OR12 boards per side of the boat! The ability to trip these boards when they have hooked a fish or just to switch out a bait or lure is what makes the OR12 Factory Rigging so special.



Stacking three or more OR12 Side Planers per side of the boat is no problem thanks to the standard factory rigging that makes it easy to release the board while keeping the board pinned in position on the line.

To trip a board simply take the rod out of the rod holder and give the rod tip a sharp snap. This will trip the line free of the OR19 release on the bracket and cause the board to swing backwards. Remember the OR16 is still holding the board firmly in place on the line. Once tripped the board will start to slip backwards out of the trolling pattern and can be reeled in directly up the back of the boat.

This rigging option makes it so easy to land hooked fish or switch out baits without having to worry about clearing other lines or tangling lines.

### THE LINE IS THE KEY

To allow the factory rigged OR12 Side Planer to function properly, monofilament, copolymer or fluorocarbon lines must be used. The OR19 and OR16 releases and clips are not designed to function with super lines.

### SUPER LINE RIGGING

Anglers who want to use super lines as their main line can still rig the OR12 Side Planer to release as described above with a small modification to the rigging. Instead of placing the super line between the rubber pads of the OR19, half hitch a rubber band around the super line and place the rubber band between the jaws of the OR19. Then instead of just putting the line behind the pin on the OR16 Pro Snap Weight Clip, place the line behind the pin and then wrap the line once around the OR16 before placing the line between the rubber jaws.

This rigging modification allows anglers to stack multiple boards per side of the boat and still release them as desired no matter what kind of fishing line is used.

### THE EASY RELEASE METHOD

A simple trick for making the line trip easily from the OR19 release on the bracket of the Side Planer is to loop the line around your finger a few turns and place these twists of line into the OR19 release. This method creates a small loop of line that pops free of the release with amazing smoothness when a fish is hooked. In fact, in most instances the fish itself will trip the line from the front release.

The same trick works when trying to lighten up the release tension on heavy tension downrigger releases.

### LAND MORE FISH

Rigging the OR12 to release when a fish strikes has several advantages. The obvious reason is that anglers can stack multiple board lines per side of the boat and never have to clear lines to fight fish.

Another less obvious reason is that when an angler fights a fish with the board still engaged on the line, it’s much more difficult to reel in the fish and board. The fish is also experiencing more resistance and in many cases a powerful fish has the leverage to tear free and escape using the resistance of the un-tripped board.

Fighting a fish on a tripped board lets the rod do the shock absorbing work it was designed to provide. More of the fish that are hooked are landed using this unique rigging method. Even better, every Off Shore Tackle OR12 Side Planer comes factory rigged and water ready.

### THE MORE THE MERRIER

It’s true that the more lines an angler fishes, the more fish that are going to be caught. At Off Shore Tackle we believe an angler should be allowed to fish as many lines as allowed by law. The “more the merrier” really is true when it comes to trolling with in line boards like the famous OR12 Side Planer. At Off Shore rigging more lines doesn’t mean more work, it just means more fish.

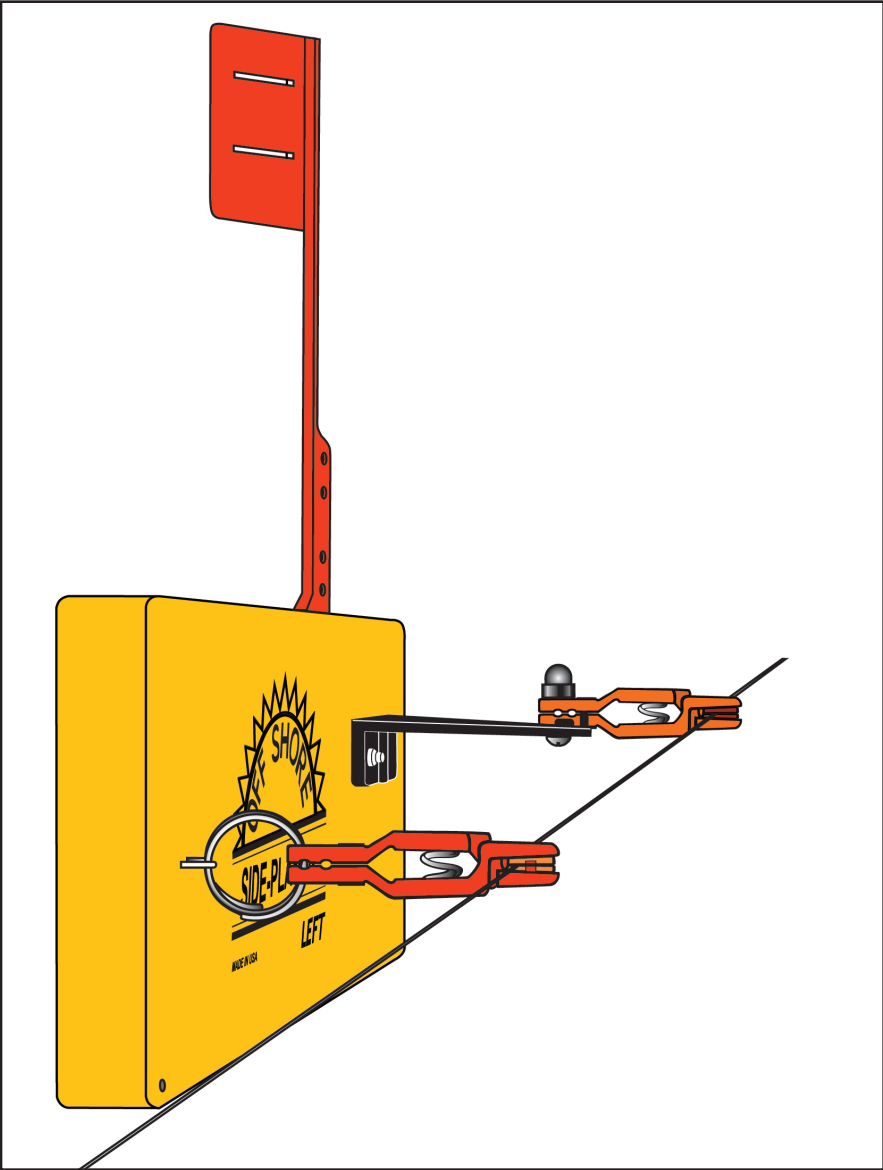



# OFF SHORE TACKLE, OFTEN IMITATED, NEVER DUPLICATED

BY NICK DESHANO

We've been using the phrase "Often Imitated - Never Duplicated" for many years and it's never been more true than right now. Just because a product says Off Shore on the package doesn't mean it's made by Off Shore Tackle or made in America.

In recent years a wealth of Chinese made copies of our products have hit the market and are primarily sold at mass merchants and through on-line retailers. Please make sure that when you are buying Off Shore

Tackle products that you are buying from a reputable dealer and that the products are actually manufactured by Off Shore Tackle of Port Austin, Michigan.

There are many companies using the Off Shore name as well as our product designation names to sell a wide assortment of Chinese made knock offs. For shoppers who use EBay, it's especially important to shop carefully.

Off Shore Tackle has spent large amounts of time and money to develop fishing products that provide the best performance and quality in mind.

Our customers work hard to have money to spend on fishing gear and most have limited time to spend on the water. By purchasing quality products, anglers can spend more time fishing and less time fixing and fighting with gear.

At Off Shore Tackle, we are committed to keeping our products made in America and to support the American worker. Thank you to all our customers for your continued support. Help us to keep the economy strong and fishing the most popular pastime in America.

## THE TATTLE FLAG™ CONTINUES TO EVOLVE

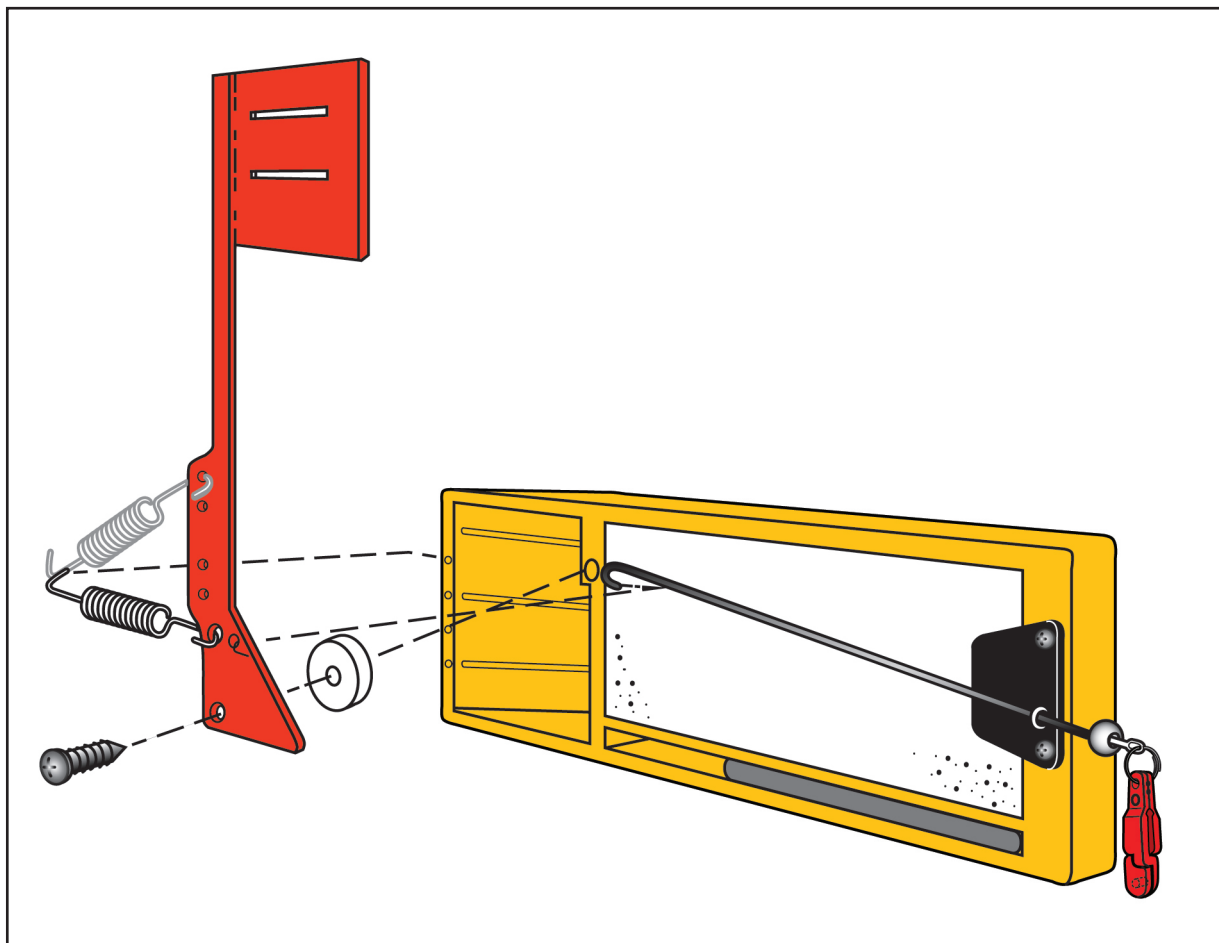

Illustration shows an OR12 being equipped with the 2017 improved version of the Tattle Flag™.

BY MARK ROMANACK

When Off Shore Tackle introduced the OR12TF Tattle Flag™ some years ago, it set into motion a series of events no one could have predicted. The popular spring loaded planer board flags have helped countless board trollers detect more strikes and get the most from their time on the water.

"One of the biggest hurdles associated with fishing in line boards is developing a skill for telling when a fish has been hooked," says Nick DeShano of Off Shore Tackle. "Planer boards like the famous OR12 Side Planer, do such a great job of getting lures and baits out to the side of the boat, sometimes it's tough to tell when a fish has been hooked. It's especially difficult to read planer boards when anglers are dealing with rough seas or small fish like sub-legal walleye and non-target species like sheepshead, white perch or white bass. Often these fish are hooked and get dragged along without the angler realizing it."

The spring loaded Tattle Flag™ system allows the board's flag to fold down when a fish is hooked. Even first time board trollers can readily tell that when the flag is down they have hooked a fish using the Tattle Flag™.

A simple stainless steel linkage, spring and line release system allows the Tattle Flag™ system to function. The Tattle Flag™ system is so sensitive it even works if the lure fouls on debris like floating weeds.

A stainless steel linkage arm connects the release on the bracket of the board with a second release mounted on the opposite end of the linkage arm. When a fish is hooked more pressure is applied to the linkage arm, pulling the spring loaded flag down in the process.

Ingenious and simple, the Tattle Flag™ has become so widely accepted that all the other competitors of Off Shore Tackle have copied this concept. It's interesting to note that while our competitors have recognized the "marketing value" of the Tattle Flag™, no one to date has built a better mouse trap.

"One of the biggest hurdles associated with fishing in line boards is developing a skill for telling when a fish has been hooked."

*Nick DeShano*

Competitor products are built with inferior releases, lightweight wires and springs not nearly up to the task of serious trolling.

New for 2017 Off Shore Tackle has revisited the concept of the Tattle Flag™ and made it one notch better. One of the limitations of the Tattle Flag™ system is making it sensitive enough to detect light strikes means that the flag would also fold down when trolling with heavy resistance lures like deep diving crankbaits and other heavy duty trolling gear. The original Tattle Flag™ system featured four spring adjustment settings on the nose of the OR12 Side Planer board. The improved Tattle Flag™ system feature four additional or a total of eight spring tension settings. The extra spring tension settings are achieved by adding a tab with four additional holes to the flag stem.

Adding more spring tension settings to the flag stem allows anglers to adjust the Tattle Flag™ from ultra light to ultra heavy settings. With eight custom spring tension settings, anglers who use the Tattle Flag™ can adapt to all trolling situations from pan fish to muskie and everything in between. No longer does trolling with deep diving crankbaits, heavy Pro Snap Weights, diving planers or lead core and copper line pose a problem for the improved OR12TF Tattle Flag™ system.

Moving forward, all OR12 Side Planers are factory equipped with the new flags. Anglers can still purchase the OR12TFEK Economy Tattle Flag™ Upgrade Kit that includes the necessary linkage arm, spring, washers and hardware needed to convert a regular OR12 into a Tattle Flag™ OR12.

These new flags with the extra tension setting tab will also be available for purchase for our customers who wish to upgrade their current OR12 boards. The new upgrades to an already popular Tattle Flag™ product are just another reason why Off Shore Tackle is Your Leader in Trolling Technology.



# COMING SOON: THE OR38 AWESOME CRAPPIE BOARD

BY MARK ROMANACK  
WITH TOMMY SKARLIS

In 2013 when Tommy Skarlis won the Crappie Masters National Championship he forced the crappie anglers of Grenada Lake and all of America to stand up and take notice. Not only did a relative new comer to the world of competitive crappie fishing take home all the marbles in a national event, he did it trolling crankbaits using the Off Shore Tackle OR12 Side Planer in line planer board.

Prior to Skarlis' ground breaking win on Lake Grenada in Mississippi, no other professional angler had ever won a major crappie fishing event using planer boards. The win not only created a new competitive standard, it set Skarlis on a path of developing a planer board built especially with the crappie fishing enthusiast in mind.

"Most in line planer boards on the market are designed for targeting walleye, trout, salmon and other larger species," says Skarlis. "The new OR38 Awesome Crappie Board, by Off Shore Tackle was built from the ground up to meet the needs of crappie anglers who routinely troll with small jigs, jig-spinners, crankbaits and small spoons."

The OR38 Awesome Crappie Board is designed to float, plane quickly to the side and create as little resistance in the water as possible. Ideal for fishing with the light lines and light action rods crappie anglers favor, this new board is also unique in that anglers can stack two, three, four or more board lines per side of the boat.

Each OR38 comes factory supplied with an OR10 (yellow) line release on the bracket of the board and an OR16 (red) Pro Snap Weight Clip mounted to the tail of the board. To rig up an angler simply needs to let his lure out the desired distance behind the boat and then place the fishing line between the rubber pads on the OR10 release. Next the OR16 Pro Snap Weight Clip is opened up and the line placed behind the small plastic pin located in the middle of the rubber release pads.

Rigged in this manner the board planes out to the side beautifully and when a crappie is hooked, the angler can easily trip the line from the release on the bracket with a little snap of the rod tip. Once the line is released from the bracket, the OR38 spins around but remains attached to the line thanks to the OR16 Pro Snap Weight Clip. Because the board is no longer planing, the hooked fish starts to slide to the back of the boat making it possible for a fish hooked on an outside board to be landed without having to clear any other planer board fishing lines!

"The beauty of the OR38 Awesome Crappie Board is that anglers can fish a few board lines off each side of the boat to spread out lures and cover more water," explains Skarlis. "At the same time board fishing opens up the back



2013 Crappie Masters National Champion Tommy Skarlis is helping to popularize trolling for crappie using the new OR38 Awesome Crappie Board.



of the boat to land hooked fish and allows savvy anglers to fish bonus trolling gear like flat lines."

Another useful feature of the OR38 is this board can be rigged to fish on either the port or starboard side of the boat. The bracket is easily reversed, making it easy to fish the OR38 on either side of the boat and also to break the board down for storage and transport.

The OR38 Awesome Crappie Board was designed with crappie trolling in mind, but this lightweight planer is also handy for fishing steelhead in rivers, targeting walleye in shallow water and for trolling up other aggressive pan fish species like white bass, rock bass and striper/white bass hybrids.

The OR38 Awesome Crappie Board will be on retail shelves in 2017. The OR38 will also be available for sale online at [www.offshoretackle.com](http://www.offshoretackle.com).

**NOTE:** Due to the OR38 having an air chamber, do not store planer board where it can be exposed to prolonged periods of extreme heat.

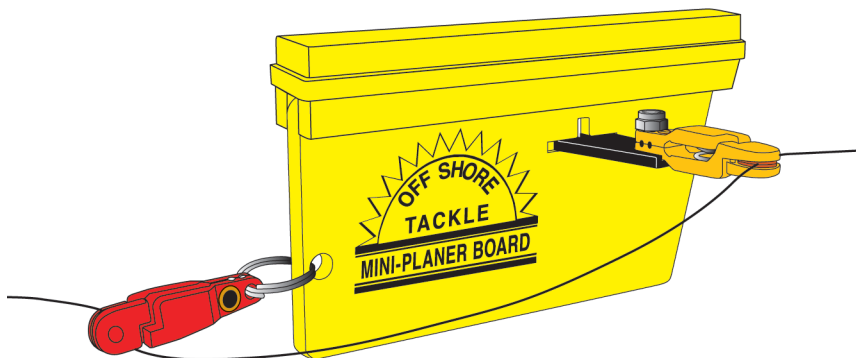

OR38 Awesome Crappie Board shown rigged for running off of the port side of the boat.

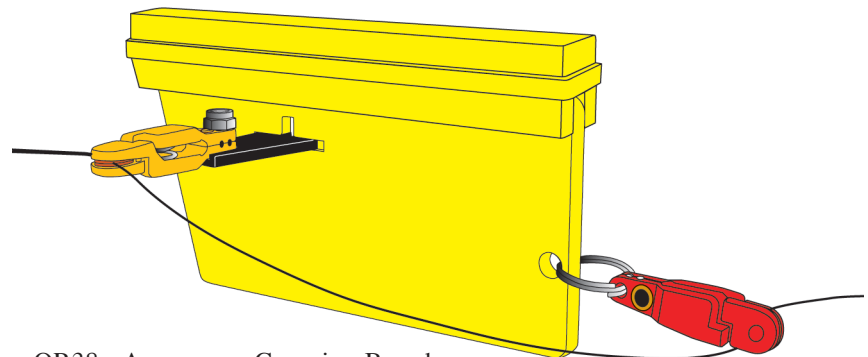

OR38 Awesome Crappie Board shown rigged for running off of the starboard side of the boat.

## PLEASE NOTE

The various fishing/rigging methods outlined in this publication are subject to state by state regulations. Before using any fishing/rigging method, make sure to consult your local Department of Natural Resources fishing directory to confirm local fishing regulations.





This photo shows the DeShano family has a four generation passion for fishing and a commitment to manufacturing the best fishing tackle money can buy. In the middle is Lou, on the left, Bruce, on the right is Nick and top middle is Ari.

# OFF SHORE TACKLE, A FAMILY TRADITION

BY NICK DESHANO

I'm fortunate enough to have been involved in the fishing industry my entire life. I can remember packaging releases at home when Off Shore Tackle was in its infancy in the 80's. When I was old enough, I was a first mate on my dad's charter boat on Lake Huron. From there, as the business grew, I became more involved and now here, I am at the controls of a wonderful business my father built. We've had good times, as well as many struggles along the way but one thing has remained consistent in the process; family.

The fishing industry is very family oriented. Most of us that enjoy getting outdoors have learned many life lessons through fishing whether it's in the back of a boat or on the river bank. Last summer I got to watch my 6 year old son catch his first walleye (off an Off Shore planer board, of course). What really made it special was that my dad and grandfather were there to see it too.

With all the distractions kids have today, fishing has more competition for their attention than ever. With my son, I chose to embrace the options. Let's face it, fishing can be boring for young children sometimes. What I chose to do is

**"Every angler wants their kid to love fishing as much as they do, but forcing them to go is a sure fire way to make them hate it forever."**

*Nick DeShano*

let my son bring his electronics along. My main objective was to get him to have fun on the water and I didn't really care how.

I let him play with his iPad and got his attention when a fish was on so he could reel it in. If he wanted to play in the bait bucket or live well, I let him. Sometimes I gave him a rod to dangle over the side, anything to keep his interest. I hear stories about parents dragging their kids on the boat kicking and screaming. They say "oh, they will get used to it eventually". Stories like that make me shudder. Every angler wants their kid to love fishing as much as they do, but forcing

them to go is a sure fire way to make them hate it forever. If you make it fun for them to be with you, they will take to it and enjoy the sport as much as you do.

Off Shore Tackle, as well as our Pro Staff, is committed to growing our sport through young anglers. Pro Staffers such as Greg Karch and Marianne Huskey are highly involved in teaching our youth about fishing. Greg has a website called [learn2fishwithus.com](http://learn2fishwithus.com) that is a great resource on how to grow the sport. The NPAA (National Professional Anglers Association) have also made youth anglers a cornerstone of their organization and have partnered with the Future Angler Foundation. The FAF not only promotes new youth anglers, but also is intended to grow the sport by involving new anglers of all ages. You can find more information about the FAF on the website at: [www.futureangler.org](http://www.futureangler.org). Most of the local fishing clubs also have youth programs.

I've come a long way since the days of packaging releases watching GI Joe cartoons and am very proud of what Off Shore Tackle has become. I think the future is very bright for the sport of fishing and can't wait to see what's around the corner!



# GETTING DOWN WITH DOWNRIGGER RELEASES

BY MARK ROMANACK

Off Shore Tackle produces downrigger releases for every conceivable “control depth” fishing situation. Downriggers are the ultimate tool for controlled depth fishing, but a downrigger is useless without the help of a dependable and well designed line release.

Downrigger releases may look simple, but their design is critical to proper function. For a downrigger line release to function properly it must hold the fishing line firmly enough that adequate bend can be achieved in the downrigger rod. Creating that classic “C” shaped bend in the downrigger rod is often believed to be about getting a good “hook set” when the fish strikes. Actually the bend in the fishing rod is designed to help take up slack line as quickly as possible when a fish strikes and the line release trips.

The hook set occurs when the fish strikes at the trailing lure and the line release has enough tension to hold the line securely until the struggling fish “sets the hook itself” and seals the deal. A line release that doesn’t have adequate tension will release the instant a fish touches the lure and in turn will lead to lots of bites that don’t yield hooked and landed fish.

Most seasoned downrigger anglers would prefer that the fish strike and get a solid hook set without the line popping free from the release. Instead the angler grabs the rod and trips the release with a quick upwards movement of the rod. At the same time slack line is reeled in as quickly as possible. This methodology insures that the fish that bite are hooked solidly and the line comes tight on the fish as fast as possible.

In other words, it’s better to select a downrigger release with a release tension that’s a touch heavy than one that’s a touch too light.

This is precisely why on most charter boats the captain or first mate will grab a rod with a fish on the downrigger, trip the release and reel up tight against the fish before handing off the rod to a customer. Any hesitation at this critical instant almost guarantees that the fish will escape.

## OR1 MEDIUM TENSION DOWNRIGGER RELEASE

The first product introduced by Off Shore Tackle was the OR1 Medium Tension Downrigger Release (black in color) and this product continues to dominate among downrigger releases. The large rubber pads of the OR1 are designed to function perfectly with 10-25 pound test monofilament, co-polymer and fluorocarbon trolling lines.

The OR1 sees heavy use among Great Lakes trout and salmon anglers.

## OR4 LIGHT TENSION DOWNRIGGER RELEASE

The OR4 Light Tension Downrigger Release (white in color) is designed for targeting smaller fish like walleye, kokanee salmon, brown trout and trout species commonly found on in-land lakes and impoundments. The OR4 features the same oversized rubber pads and also functions flawlessly with 10-25 pound test fishing lines.

## OR8 HEAVY TENSION DOWNRIGGER RELEASE

The OR8 Heavy Tension Downrigger Release (red in color) is popular among anglers who fish using flashers, dodger, lake trolls, cowbells and other attractors that have a lot of resistance in the water. The OR8 features the same oversized rubber pads of the OR1 and OR4, but with a double spring tension that guarantees enough tension for fishing at high speeds and in deep water.

Besides Great Lakes trollers who fish a lot of attractor rigs, the OR8 is also popular among muskie trollers and salt water trollers too.

The OR1, OR4 and OR8 are flawlessly designed downrigger releases that will provide years of trouble free service. Often Imitated but Never Duplicated, no one makes better downrigger releases than Off Shore Tackle.

Understanding how to get the most from downrigger releases has helped catch just about every major species of freshwater game fish using the depth control of downriggers. Off Shore Tackle manufactures the largest assortment of downrigger releases on the market.

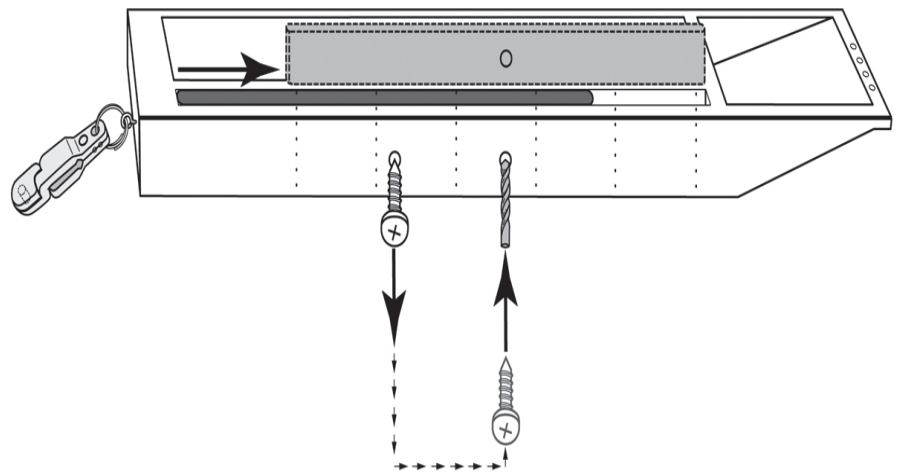

# THE OR12 SIDE PLANER BALLAST WEIGHT ADJUSTMENTS

BY MARK ROMANACK

The Off Shore Tackle OR12 Side Planer comes factory equipped with a ballast weight mounted into a slot at the bottom of the board. This weight is positioned in the board and screwed in place at the factory to provide the best combination of features for anglers who troll a wide variety of gear including crankbaits, Snap Weights, Tadpole Divers, lead core line and copper line set ups.

Trollers who fish with Off Shore Tackle’s OR36 Magnum Tadpoles and long lengths of lead core or copper line, might want to consider making a minor modification to their boards. By removing the screw in the bottom of the board, the weight can be removed and repositioned further forward in the board. A space of approximately one inch in length is available for moving the weight forward in the board.

Moving the ballast weight forward causes the board to run flatter in the water and gives the board more grip or bite when towing heavy gear. Anglers who routinely fish with more than 10 colors of lead core or copper line rigs longer than 300 feet will find this simple modification allows the OR12 Side Planer to plane significantly further to the side even when pulling heavy trolling gear.

To keep the ballast weight secured, simply make a mark on the weight where the factory screw is installed. Once the weight has been repositioned, it’s a simple step to drill a small hole in the bottom of the board and re-install the screw to secure the ballast weight stays in place.

Adjusting the ballast weight in the OR12 Side Planer allows anglers to “customize” how the board runs when pulling specific gear. The typical angler will probably find no need to make any adjustments to the ballast weight, but for those anglers who like to “tinker” the improved OR12 Side Planer makes that process simple and easy.

**NOTE: Even though this goes without saying, you need to use extreme caution if you choose to covert your older style OR12’s when removing the plastic stop inside the weight cavity to allow you to move the ballast forward when needed.**

# DON’T BE FOOLED BY IMITATIONS!

We are “Often Imitated, Never Duplicated”. Make sure that when you purchase your products that they are the Original Off Shore and Riviera products that have proven to be successful and dependable! We take pride in bringing you the BEST quality!



# COMPANY MISSION STATEMENT

Our company's foundation is based on presenting products to the consumer that result in a more productive fishing experience by using the best materials available that are as eco friendly as possible. We have always set our standard's high for our consumers to have the best results. Our products are "Often Imitated but Never Duplicated." This is why Off Shore Tackle LLC remains, *"Your Leader in Trolling Technology."*

## TADPOLE RESETTABLE DIVING WEIGHTS

BY MARK ROMANACK

The Off Shore Tackle OR36 series of Tadpole Resettable Diving Weights have been widely accepted as the "trolling weight of choice" among a growing number of open water trollers. Walleye anglers are especially fond of Tadpole Divers for pulling spinner rigs in open water. The Tadpole is also useful for trolling flutter spoons and also crankbaits.

Simply tie the heavy duty snap that comes with the Tadpole onto the end of your fishing line, attach your favorite crawler harness (spinner rig) to the tail of the Tadpole Diver and send this rig back! Tadpole Divers can be fished as flat lines or fished in combination with boards like the OR12 Side Planer and the OR34 Mini Board.

### THE RESETTABLE FEATURE

Anyone who has fished a Tadpole Diver recognizes that they are the ultimate trolling weight because they are easy to fish. Tadpoles are also efficient trolling tools because they can be reset without having to reel them in. Say you hook a fish trolling a spoon behind the Tadpole. Half way to the boat the fish comes off. No worries, just give the Tadpole Diver a little slack line and it will auto-

matically reset itself into the diving position again. Set it back to the lead length it was running at before and you're in business.

### RESISTANCE EQUALS BETTER HOOK UPS

The diving characteristics of the Tadpole Divers help these trolling weights achieve significant depths even when trolled using modest lead leads. Also, because the Tadpole is diving it has considerable resistance in the water. When a fish bites a harness or lure trailed behind the Tadpole that fish gets an instant "hook set" because the Tadpole is resistant to being pulled backwards. This effect is similar to what happens when a fish strikes a lure trailed behind a downrigger weight.

The "built in" hook set helps the Tadpole hook and land more fish than other in line weight systems. Once the fish is hooked and the line is pulled taut, the Tadpole automatically slips from diving mode into fish landing mode. The snap attached to the tow arm of the Tadpole rests in the elbow of the tow arm when the Tadpole is diving. When a fish is hooked that snap slides to the forward position, converting the Tadpole from a diver instantly into an in line weight that has little resistance in the water.

This design allows anglers to have the best of

both worlds. When fishing, the Tadpole dives and has the necessary resistance in the water to insure positive hook sets. Once a fish is hooked, the Tadpole converts automatically to an in line sinker that can be reeled in with little or no resistance. All the angler feels is the fighting fish. Now that is one slick trolling sinker!

### TROLLING LEADERS

The Tadpole Divers function best when harnesses and other lures are fished on leaders ranging from 60 to 84 inches in length. Most commercially produced harnesses are not this long. Fans of the Tadpole Diver typically tie their own "open water" harnesses that are a little longer than those normally used on a bottom bouncer or other trolling weight.

### ADDING ATTRACTORS

Because the Tadpole does such a great job of diving to depth, many anglers have discovered they can add various attractors directly to the back of the Tadpole Diver before adding their favorite harness or trailing lure.

One set up in particular that is gaining in popularity across Lake Erie and Saginaw Bay is to add a 4 inch Big Al Fish Flash directly to the back of the Tadpole using the heavy duty snap provided. The harness is then added to the back of the Fish Flash.

Because the Fish Flash spins on its own axis the Tadpole takes it to depth without sacrificing any diving depth. Adding attractors like the Fish Flash to Tadpole Divers works best when fishing in stained to murky waters. The extra flash lures fish from greater distances. Once those fish are in the trolling pattern, the trailing harnesses or lures can better do their job of triggering strikes.

### COLOR MATCHING

For anglers who are interested in adding attractors to the Tadpole Diver, a good rule of thumb is to match the attractor color to one of the primary colors on your terminal tackle. For example, if you're pulling Colorado blades that are silver in color, a silver flasher on the Tadpole is a good choice.

### SIZE CHOICES

The Tadpole Diver is available in four different sizes including the No. 1, 2, 3 and Magnum. Shallow water walleye anglers spend most of their time trolling in 25 feet of water or less are using the No. 1 and 2 sizes, but the No. 3 works also great as a flat line fished off the corners of the boat.

Anglers who are targeting fish deeper than 30 feet will want to give the No. 3 and Magnum versions a try.



Dale Voice of Cadillac, Michigan is a big fan of Tadpole Divers for targeting open water walleye with spinners.

# CRAPPIE TROLLING — SOUTHERN STYLE

BY DAN DANNENMUELLER  
AND GARRETT STEELE

Garrett Steele and I founded the Crappie Country fishing team and have been very successful the past few years pushing crankbaits and jigs on the front of the boat. In 2011 and 2012, I won two Angler Team of the Year titles with Bill Braswell using these techniques. The art of “pushing” crankbaits and jigs was started on Kentucky Lake and has become perfected and very popular over the years.

Many of us who reside below the Mason Dixon Line had never seen or used planer boards to pull crankbaits and jigs for crappie until 2013 when Tommy Skarlis used them to win the Crappie Master’s National Tournament. Skarlis used crankbaits and planer boards to pull off an impressive win on Grenada Lake in Mississippi. After a couple years of following Skarlis’ lead, I’m happy to report that planer boards are now a common tool in our crappie and tournament fishing arsenal.

We often get asked by other anglers why is it important to use planer boards? Our answer is that planer boards are a tool which can help anglers cover a large amount of water while at the same time delivering our lures at the precise depths where the fish are located. We believe that because planer board trolling covers more water this fishing presentation is often more effective than traditional flat line trolling.

Planer boards like the Off Shore Tackle OR12 Side Planer and the up and coming OR38 Awesome Crappie Board are not just useful for trolling crankbaits and jigs. We often use planer boards when trolling with the OR36 1 Tadpole Diver. Off Shore Tackle’s OR36 series Tadpole Divers allow us to fish with jigs, crankbaits and also live bait rigs while presenting our baits at precise depth levels. Tadpole divers are especially useful when targeting crappie that are rapidly moving up and down in the water column to feed on suspended shad.

While pre-fishing on Grenada Lake for the 2016 Crappie Masters National Championship we

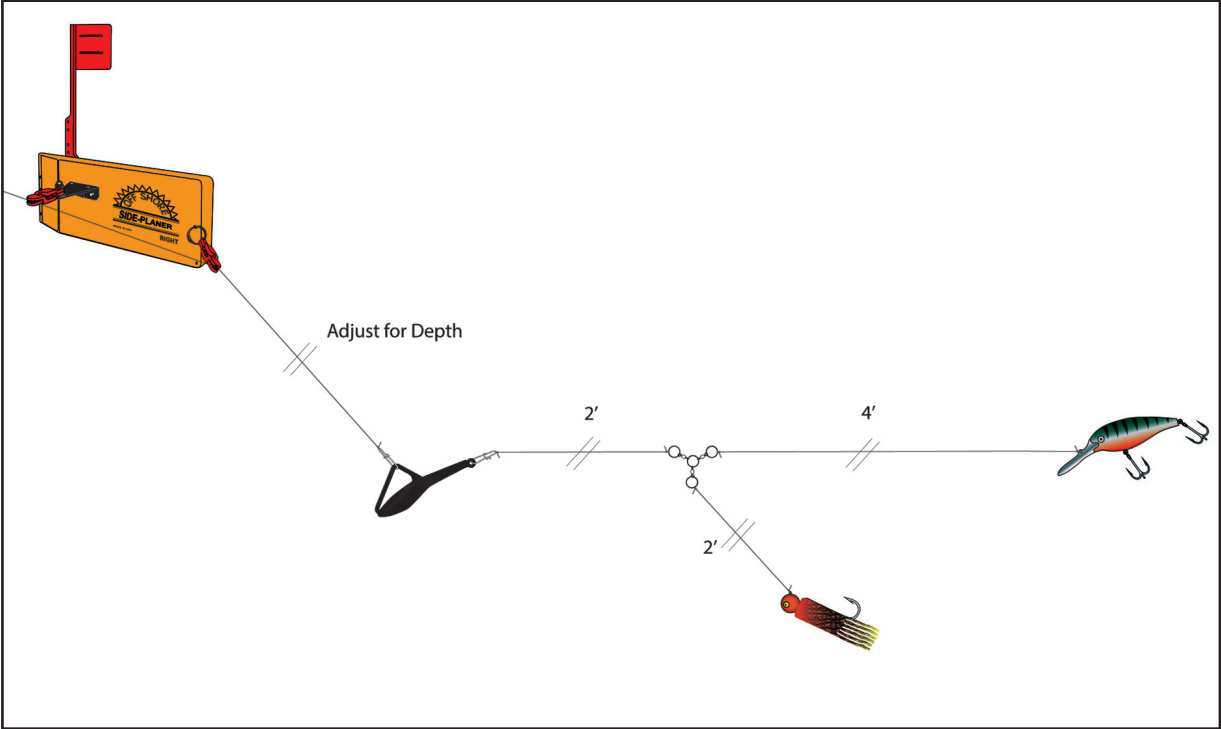

located some exceptional crappie using the OR12 Side Planers in combination with OR36 1 Tadpole Divers. The fish were holding on shallow water breaks and relating to suspended shad. Trolling with planer boards allowed us to present the boat away from these fish while presenting our lures right on target.

The Off Shore Tackle OR12s and the new OR38 Awesome Crappie Board are perfect for light line and light rod crappie trolling applications. We prefer the slightly larger OR12 models equipped with Tattle Flags™ when trolling with heavier gear like the Tadpole Divers and the smaller OR38 when fishing with crappie sized jigs and smaller crankbaits.

We recommend using line counter reels loaded with 10 lb. test monofilament to closely monitor trolling leads. The leaders we fish when using Tadpole Divers are 8 lb. test. This six foot leader features a three-way swivel and a two foot dropper

that allows us to troll using a jig on the dropper and a crankbait on the main leader. Running two lures on each Tadpole Diver helps us present more baits in the strike zone and gives us the option of experimenting with two different lure presentations at the same time.

To learn more about crappie trolling, follow us on Facebook at Crappie Country and Crappie Now as well as visiting the Off Shore Tackle You Tube channel to get more how to tips.

**EDITOR’S NOTE:** *Dan Dannenmueller and Garrett Steele are two of the top crappie tournament anglers in America. This popular team is a threat to win every tournament event they fish. Dan is also behind the CrappieNow and CatfishNow online magazines that provide great fishing information free of charge to anglers everywhere.*

WANTED

Attention retailers that carry Off Shore Tackle products! We are looking to add you to our list of DEALERS on our website. Please email us at [otcproducts@yahoo.com](mailto:otcproducts@yahoo.com) with your company name along with your city, state, country and web address for you to be added.

If you happen to be missing out on carrying our products, we would be more than happy to supply you with a list of distributors that would happily accommodate you in adding the Off Shore Tackle product line!

## MINI PLANER BOARDS FOR SHALLOW WALLEYE

BY JAMIE AND BRETT ROBINSON

Living and travelling extensively throughout Northern Ontario for fishing tournaments and family fun has given our family access to some of the finest walleye lakes around. On many of these lakes, 100 fish days are very common. Since, catching fish is usually not an issue and with the one rod per angler rule in most Northern Ontario waters, the planer board techniques used so heavily throughout the Great Lakes and more southern regions has not really come into play as much as it should have yet. However, with that said, the fish are not always jumping in our boat per say and we are always looking for ways to put larger and more fish in the boat.

Over the past few summers, one of our favorite techniques for targeting walleye in shallow northern lakes focuses on the OR34 Mini Planer Board and crankbaits. We use the OR34 Mini Planer Boards in combination with line counter reels and the Precision Trolling Data app to get our baits to

the desired.

I can’t explain the excitement Brett and I feel when a walleye slams a crankbait and buries one of our Mini Boards. Recently while pre-fishing for a tournament, we were experiencing a very tough bite. To cover as much water as possible, we started running a variety of crankbaits fished behind the OR34. We rigged both our lines off one side of the boat to troll weed edges and shorelines in the 5’ to 9’ range.

The top producing bait quickly became Yakima Bait Company’s Mag Lip 3.0 and the walleye were coming in almost as quick as we could get the boards set. The versatility of the OR34 Mini Planer Board allows you troll them off either the port or starboard side of the boat by easily changing the bracket assembly to either side. This was a key for us on this trip, since we only had 2 of them. After each pass, we reeled them up and changed the bracket to allow us to cover the weed edge or shoreline on our return pass.

CONTINUED ON PAGE 8



# MINI PLANER BOARDS FOR SHALLOW WALLEYE — CONTINUED FROM PAGE 7

On this outing, we used the “release and slide” method of rigging the OR34. With this rigging method, the board trips from the OR10 release on the bracket of the board and slides down the line via the snap swivel mounted to the back of the board. To prevent the board from sliding all the way to the lure we rig in line a barrel swivel and bead approximately five feet ahead of our Mag Lip 3.0.

Another common rigging option is to use the OR10 release on the bracket of the board and use an OR16 Pro Snap Weight Clip at the tail of the board. The OR16 has a small plastic pin in the middle of the release pads. When the line is placed behind this pin, the board can not come off the line. Rigged in this fashion, the board will release from the bracket when a fish strikes, but remains fixed on the line.

Both rigging methods are effective and the OR34 comes factory supplied with all the releases and swivels needed to rig the board either way.



## HOW TO USE YOUR MINI PLANER BOARD

Our Double Agent! The OR34 works for both sides! You decide whether you run it on the port or starboard side! It is reversible — you change sides by switching the direction of the bracket! One Board...Dual Purpose!



### PRO RIGGING

OR

### SLIDE DOWN RIGGING

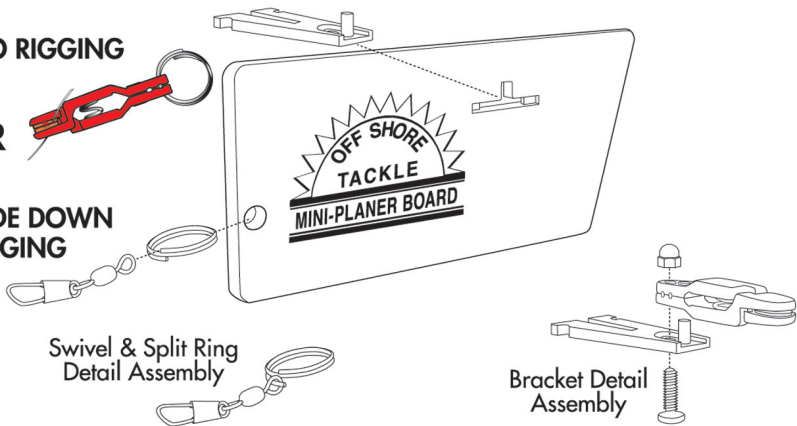

Assembly shown is for running this board off of your port side. Simply reverse the direction of the bracket to run the board off of the starboard side.



Heavy Tension



Light Tension

You can adjust the tension of the release/clip by positioning the spring as shown above.

The pinch pad release/clip system allows you to easily attach and remove this board from your rod line. Simply let out your lure or light bait to your desired distance, place the line in the snap swivel or OR16 clip (depending on which rigging method you prefer) and then into the pads of the OR10 release on the bracket. Continue to then let out your line to the final desired distance.

The Mini Planer can be reeled in and removed easily or you can allow it to be tripped so it will slide down to a set stop ahead of the lure depending on which set up you choose. Do **NOT** let the board slide down all of the way to the lure!

# SALMON KAYAK SUCCESS STORY

BY ERIC BECKMAN

Being an owner of a bait and tackle outfitter means I’m tasked with making sure all our staff take extra time to show people how to use the products that we sell. Our goal at Snug Harbor is to help our customers thru any obstacles that they are encountering while on the water to assist in their success.

This past September, a kayak angler came in with his kayak strapped to the top of a jeep. He walked in and said, “I’m here to catch a salmon”, and we went to work setting him up. With the growing popularity of kayak fishing, we have set up many people to accommodate the limitations of fishing from a non-motorized craft.

The main hindrance to overcome is getting the baits down into the target water since kayak anglers don’t have the advantage of common fishing tools like downriggers. We opted to sell him an Off Shore Tackle OR20 Pro Weight System and two popular plugs. We put a 3 oz. Pro Guppy Weights on two of the OR16 Pro Snap Weight Clips and a 2 oz. on the other two OR16’s.

Not knowing how fast he could paddle and for how long, we decided that mid water column was our target for the fish he was after. After picking a productive spot on the lake map with a depth of 40’, we instructed him to set the OR16 with the 3 oz. guppy weight 25’ in front of the plug, let out an additional 30’ of line, set it in the holder and paddle like crazy. He paid his bill, and hit the water with a plan.

Two hours later, our kayaker returned. He literally runs in the front door with his arms held above his head, smelling like a salmon with a smile from ear to ear and yells, “I got two”, he shouted! We all cheered, and shared high five slaps! I gave the angler an Off Shore Tackle decal for his kayak and another happy customer headed home.

I’m 100% certain this guy will be back. While the OR20 Pro Weight System might have been designed with traditional trolling chores in mind, the Pro Snap Weight concept works great for other fishing applications as this kayak angler proved convincingly.

EDITOR NOTE: Eric “Skeeter” Beckman is the owner of Snug Harbor Resort on the shores of Muskegon, Lake near Muskegon, Michigan. An avid angler who is always willing to share his knowledge of fishing with others. In this era of “mass merchants” and “here today and gone tomorrow” sales associates, Eric and his staff are a shining example of how outdoor retail used to be. A visit to Snug Harbor not only provides anglers a chance to purchase the items they need and the experience includes friendly advice that just might put an extra fish or two in the boat or in this case... kayak!

## DISCLAIMER

Product features, opinions, and/or individual’s contact information may have changed since these articles were originally composed.



# CLEAR WATER STRUCTURE TROLLING STRATEGY

BY ERICH CARLSON

With Lake Huron only couple miles from my home, I'm privileged to have the opportunity to fish some fantastic walleye water. May through September northeast Michigan gets a very healthy migration of walleye out of the Saginaw Bay that heavily supplements our resident fish. The same extreme water clarity that makes the Thunder Bay National Marine Sanctuary one the premier fresh-water diving destinations in the world, presents a unique set of challenges to the anglers that fish these waters.

I truly believe the experiences of fishing these waters over the years have molded me to be much better wall-eye angler. In many areas of the country, clear water might be considered 8-10 feet of visibility. In the northern Great Lakes, it is very common to be able to stand up on the bow of the boat and visually spot walleye 25 to 30 ft down. When you can see your spinner rigs flashing 20 feet below the surface, that water is clear!

I recall a good friend of mine coming up to pre-fish a tournament a few years back, and called me up and said, "Hey! I burned almost a whole tank of gas and can't find stained water anywhere!" I just laughed and told him "Good Luck!"

In many areas of the Great Lakes, clear water is the order of the day, and often we are faced with crystal clear conditions that can seem to make catching walleye a daunting task. When dealing with challenging conditions, no matter the location, we must remember that wherever walleye swim, they can be caught. They may not come easy, and at times it may be very difficult to figure out the pattern, but no matter the conditions walleye have to eat.

It's our challenge as anglers to figure out the what, when, and how they want to eat. I honestly can't think of a more important scenario for employing the use an Off Shore Tackle OR12 Side Planer than trolling for walleye in crystal clear water. One of the best ways to catch more walleye is to use Off Shore Tackle's OR12's to deliver baits by sending them WIDE, LONG and LOW.

## GO WIDE

Most serious anglers already know that a set of Off Shore Tackle Side Planers is one of the most crucial parts of any trolling spread, but boards are absolutely vital when trolling for clear water walleye. A few important but simple adjustments to your trolling spread can and does drastically increase trolling success.

It's important to realize that in crystal clear water your boat WILL spook fish! Clear water "eyes" are extremely boat shy. Simply widening out your board spread can often be the difference between success and failure.



**These young anglers are learning that Off Shore Tackle OR12's are an important piece of equipment when fishing walleye in clear waters.**

I often find that I can't get consistent bites unless I'm pushing the outer limits with my OR12 Side Planers. More often than not, the majority of my fish come on the outside boards that are reaching out 200 feet or more from the boat. No matter if I'm fishing cranks, crawlers, or spoons, the key is to get them wide. Really Wide!

## GO LONG

Setting your baits further behind the boat than normal is the next step in helping put more clear water "eyes" in the boat. Off Shore Tackle's OR20 Pro Guppy Weight System and OR36 series Tadpole Diving Weights are perfect options for optimizing clear water trolling presentations. Both of these trolling weights do a great job of delivering live bait rigs or lures into the strike zone.

I intentionally lengthen my leads while fishing clear water in certain situations. For example, when trolling break-line structure some of the most productive areas are rock to sand transitions found in 21-25 feet of water. While I can easily get an OR36 2 Tadpole and a #5 Colorado spinner set at 25 feet back to run 20 feet down at 1 mph, I instead use the same harness set up with the 50/50 method rigging method and a OR20 ½ oz. Pro Guppy Weight and get it to the same depth. The difference is

the Pro Guppy Weight is fishing an additional 75 feet further behind the board.

When targeting deeper structure, say, 40-50 feet or more, I typically will use the OR36 Tadpoles to get my baits down to depth. An OR36 2 Tadpole rigged with a harness at 1.0 mph will put my bait down 44 feet with 100 feet of line behind the board.

What's the big deal? The bait and depth is the same, but often it's the longer leads that are getting bit consistently. Occasionally I'll even run extremely long with no weight, where I've found that my favorite #5 Buggy's Baits Colorado Blades run roughly 5-6 feet deep per 50 feet of line at 1.0 mph. Placing this harness 100 feet back with no weight will then put me down roughly 10 to 12 feet deep. Remember that experimentation with lead lengths and blade sizes is a must for fine tuning clear water presentations. Get creative when it comes to lead lengths. That extra distance behind the board is sometimes the determining factor between getting bit or not.

CONTINUED ON PAGE 12

# FLIP OR FLOP THAT OR16 PRO SNAP WEIGHT CLIP

BY CAPTAIN TERRY KUNNEN,  
TKOCHARTERS.COM

Small details become surprisingly important when you perform the same task thousands of times a year. I am always looking for ways to improve my fishing efficiency. One of my adjustments every season is to make a half turn to the trailing OR16 Snap Weight Clip on the back of all my OR12 Side Planer Boards.

Seem silly? When picking up a board, most anglers generally grab it with their off hand and pinch the OR16 with the stronger dominate hand. The next time on the water, take special note of where that pin is on the OR16 when clipping it

onto the line. Remove the board and repeat the process of putting the line behind the pin 4 or 5 times to check for a pattern.

A pattern of what side of the clip has the pin and what feels right will quickly evolve. When trying to set the OR16 clip onto the fishing line, having the pin in the same place (far side of the clip for me so I can see it) makes a huge difference for speed and accuracy. Take a few minutes when that odd clip shows up next time and open that split ring and flip that clip over. As anglers we only have so many hours to fish, so make the most of every minute on the water. Flip or flop that OR16 and never fumble getting a board on or off the fishing line again.





# OFF SHORE TACKLE

## Your Leader In...

### Side Planer Boards

#### Model # OR34 Mini Planer Board



Each OR34 Mini Planer includes an OR10 release, OR16 clip, black bracket, split ring, snap swivel, nylon nut, 6/32 x 1/2" screw, and instructions. One board...Dual Purpose....It's Reversible and runs directly off of your rod line! Ideal for light tackle fishing.

#### Model # OR12L Side Planer Left

#### Model # OR12R Side Planer Right



Each OR12 Side Planer includes a stationary flag, one OR19 (orange) release, one OR16 (red) clip, instructions and is carefully ballasted to run flawlessly in rough water off of your rod line. Ideal for several species of fish.

#### Model # OR37L SST Pro Mag Planer Left

#### Model # OR37R SST Pro Mag Planer Right



The SST Pro Mag Planer includes a stationary flag, one OR18 (black) release with lock nut, one OR16 (red) clip, instructions and is designed to carry large, heavy baits further to the side than any other in line planer! Perfect for long copper and lead core lines as well as oversized baits used for Striper, Salmon, Trout, Muskies and Walleye. The SST Pro Mag Planer was designed to be correctly balanced for pulling heavy weights, no modifications or additions are needed! The OR16 (red) clip on the tail of the board ensures that your board will stay on your fishing line.

### Tattle Flag Upgrade Kit

#### Model # OR12TF Tattle Flag Upgrade Kit



Each kit includes flag, 2 OR16 clips, wire, spring, washer, screw eye, split ring, 6/32 screw and instructions. One kit will upgrade one OR12 Side Planer.

#### Model # OR12TFEK Tattle Flag Upgrade Economy Kit

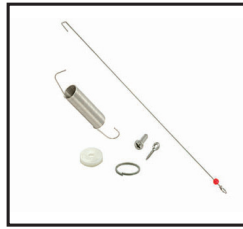

This kit will only work by using an OR12 Side Planer and two OR16 (red) clips that you previously purchased as this kit just contains ONLY the hardware which consists of a wire, spring, washer, screw eye, split ring, 6/32 screw and limited instructions.

### Planer Board Releases

Our three full size planer board releases come with a quick clip for use on dual planer boards. Also available without quick clips as shown on order blank. Their large diameter pinch pad design holds monofilament lines securely. Tension can be adjusted further by how deeply the line is placed into the pads.

#### Model # OR3, OR3BWW, or OR3BWOW Light Tension Planer Board Release —White



This release is ideal for Walleye fishing in choppy water or Brown Trout using 10-25 pound test monofilament line.

#### Model # OR17BWW or OR17BWOW Medium Tension Planer Board Release —Black



This release is ideal for Salmon, Steelhead, Trout and Muskies using 10-25 pound test monofilament line. It can also be used to pull lead core, Snap Weights and deep diving crankbaits.

#### Model # OR30BWW or OR30BWOW Heavy Tension Planer Board Release —Red



This release is ideal for Muskies, trophy Pike and salt water fish using over 20 pound test monofilament line.

#### Model # OR18 Snapper Adjustable Tension In Line Planer Board Release—Black

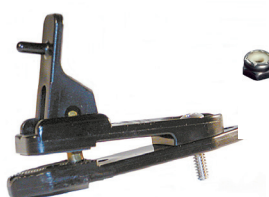

The OR18 is a full size release designed with an adjustable cam action locking arm that can be set to release at a range of tension settings or tightened down to hold even super braid lines and lead core securely. This release comes standard on our OR37 SST Pro Mag Planer and is made to attach to the bracket of our OR12 Side Planer. With the wide range of tension settings, this release is ideal for Walleye, Striper, Salmon, Steelhead, Trout, and Muskies.

Our three half size adjustable tension planer board releases come with quick clips for use on dual planer boards and split rings for use on in line planer boards. They are also available without quick clips and split rings as shown on the order blank. Tension can be further adjusted by simply sliding the spring toward the pads to increase tension or away from the pads to decrease tension.

#### Model # OR10, OR10BWW or OR10BWOW Adjustable Light Tension Planer Board Release—Yellow

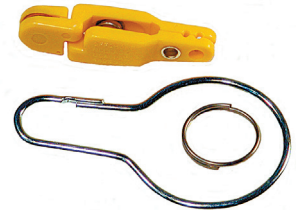

This release is ideal for light biting fish such as Walleye or smaller fish using 10-25 pound test monofilament line. Our three half size adjustable tension planer board releases come with a quick clip for use on dual planer boards and split ring for use on in line planer boards.

#### Model # OR14, OR14BWW or OR14BWOW Adjustable Medium Tension Planer Board Release—Black

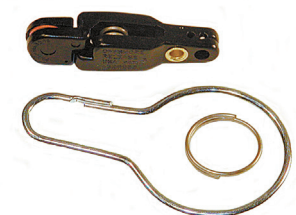

This release is ideal for dual planer board trolling for Walleye and Salmon using 10-25 pound test monofilament line. This is the release most commonly used for rigging add-a-lines or fixed slider lines among downrigger anglers.

#### Model # OR19, OR19BWW or OR19BWOW Adjustable Heavy Tension Planer Board Release—Orange



This release comes as standard equipment on the OR12 Side Planer and is ideal for Striper, Salmon, Trout, and Muskies using 10-25 pound test monofilament and lead core.

**DON'T BE  
FOOLED BY  
IMITATIONS!**

We are "Often Imitated, Never Duplicated". Make sure that when you purchase your products that they are the Original Off Shore and Riviera equipment that has proven successful and dependable! We take pride in bringing you the best!



# PRODUCT SHOWCASE

## ...Trolling Technology



### Pro Weights



Model # OR20  
Pro Weight System



Each system includes instructions, four OR16 pro clips, four split rings, two of each of the following guppy weights: 1/2 oz., 3/4 oz., 1 oz., 1 1/2 oz., 2 oz., and 3 oz. all contained in a plastic tackle box. Use as Snap Weights or In Line Weights - you decide. This system is used off of flat lines, dual planer boards and side planer boards.

Model # OR16, OR16BWW or OR16BWOW  
Pro Weight Clip—Red



This half size clip has an extra heavy spring tension and includes a split ring. They are also available without split rings as shown on the order blank. You simply position your fishing line behind the pin that protrudes through the center of the pads to hold your snap weight securely on the line.

The OR16 comes as standard equipment on the tail of the OR37 SST Pro Mag Planer, as well as OR12 Side Planer and in our OR20 Pro Weight System. It is ideal for use with snap weight fishing, super braid lines and with our tattle flag system.

### Replacement Pro Guppy Weights

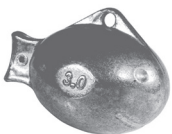

Model # OR20 1/2  
1/2 Ounce Pro Guppy Weight

Model # OR20 3/4  
3/4 Ounce Pro Guppy Weight

Model # OR20 1  
1 Ounce Pro Guppy Weight

Model # OR20 1 1/2  
1 1/2 Ounce Pro Guppy Weight

Model # OR20 2  
2 Ounce Pro Guppy Weight

Model # OR20 3  
3 Ounce Pro Guppy Weight

### Resettable Diving Weights



Model # OR36 1  
Tadpole Size 1

Model # OR36 2  
Tadpole Size 2

Model # OR36 3  
Tadpole Size 3

Model # OR36 MAGNUM  
Tadpole MAGNUM Size

### Downrigger Releases

Our downrigger releases are all full size and therefore have the large diameter pinch pad design that holds monofilament lines securely. Tension can be adjusted further by how deeply the line is placed into the pads.

Model # OR4  
Light Tension Single  
Downrigger Release, White



This release is ideal for Walleye, spring Coho, or other small to medium size fish using 10-25 pound test monofilament line.

Model # OR1  
Medium Tension Single  
Downrigger Release, Black



This release is ideal for Salmon, Steelhead, Striper and Trout using 10-25 pound test monofilament line.

Model # OR8  
Heavy Tension Single  
Downrigger Release, Red



This release is ideal for Muskie, Salmon, trophy Pike, and salt water fish using over 20 pound test monofilament line.

Model # OR7  
Light Tension Stacker  
Downrigger Release, White



This release is ideal for Walleye, spring Coho, or other small to medium size fish using 10-25 pound test monofilament line and allows you to run two lines off of the same downrigger.

Model # OR2  
Medium Tension Stacker  
Downrigger Release, Black



This release is ideal for Salmon, Steelhead, Striper and Trout using 10-25 pound test monofilament line and allows you to run two lines off of the same downrigger.

### Replacement Pads



Model # ORRP8

Replacement pads for OR1, OR2, OR3, OR4, OR7, OR8, OR17, and OR30 releases.



Model # ORRP8SN

Replacement pads for OR18 releases.



Model # ORRP16

Replacement pads for OR10, OR14, OR19 releases along with OR16 clips WITHOUT the pin protruding through the center of the pads.



Model # ORRP16HL

Replacement pads for OR16 clips WITH pin that protrudes through the center of the pads.



These items, replacement parts, & promotional items (including apparel) are available through our website.

Visit us at **www.offshoretackle.com**

★ SHOP ANYTIME ON-LINE . . . CONVENIENT AND SECURE ★



# THE OR12 SIDE PLANER, SETTING UP FOR SUCCESS

BY GARY PARSONS  
AND KEITH KAVAJECZ

The OR12 Side Planer by Off Shore Tackle is a great tool for spreading out lures and covering more water. To get the most from these boards and avoid frustrating line tangles requires a short learning curve.

## JUST STARTING OUT

For those who are just getting their feet wet trolling with in line boards, it's good advice to start out with a basic four rod/planer spread. Incorporating two board lines on either side of the boat does a good job of covering water. Keeping things simple to start with also reduces the chances of tangled lines, lost fish and other frustrations.

When running two boards per side, clear the inside board line when a fish is hooked on the outside board. This process only takes a few seconds if one angler fights the fish while the other clears the inside board line. The line that's being cleared can be reeled in quickly. Don't remove the board, just reel it in until the board touches the rod tip and then lay that line out of the way.

Clearing the inside line makes sure there is plenty of room to fight and land the hooked fish. Once that fish is landed, reset the line using the same lead length that produced the bite, put the board on the line, drop the board in the water and engage the bait clicker on the reel. Open the reel bail, place the rod in the rod holder and as the boat trolls along, line will slowly play off the reel as the board planes out to the side.

Using the bait clicker function on the reel makes it possible to reset two lines at the same time. Once the outside board is working its way out to the side, drop the cleared board line back in the water and reset that line using the same process.

Clearing lines to fight fish takes a little more time, but it virtually eliminates any chances of crossing or tangling lines. A lot of anglers like the simplicity of clearing lines and never advance beyond fishing two OR12 Side Planers per side of the boat. For those who want to incorporate a few more lines into the trolling pattern read on.

## THE MORE THE MERRIER

With just a little practice anyone can master the



Keith Kavajecz of the Next Bite TV series is one of the longest standing Off Shore Tackle pro staffers and an expert at catching walleye on planer boards.

art of trolling with two Off Shore boards per side of the boat. The next step is getting comfortable running a third board per side. When fishing three boards per side of the boat, it's a good idea to set the shallowest running lure on the outside board and the deepest diving lure on the inside board. Because the outside lure is running closer to the surface than the board next in line, it's less likely to tangle with other lines.

It's also interesting to note that the outside lines tend to catch a few more fish than the middle or inside board lines. In part this is true because the lure that's positioned furthest away from the boat does a little better job of triggering strikes from spooky walleye.

One of the tricks pros use to keep lines from

crossing when running three or more boards per side is by spreading out their rod holders starting at about the helm and spacing them evenly to just in front of the transom. Designate the rod holder mounted furthest forward in the boat to the outside board line. The rod holder furthest back in the boat becomes the inside line and of course the middle rod holder holds the middle board line.

When the outside rod/board line is placed in the rod holder the rod tip should be positioned almost vertical. The next rod holder is positioned so that rod tip is at a slightly lower angle and the third line and rod tip is positioned a little lower yet. Spacing out rod holders and staggering the rod tips helps to provide critical separation between the board lines.

Tangles or crossings of planer board lines occur most often when rod holders are too close together and also when the boat is turned sharply. Often called "wave jumping" this problem can be eliminated by following these simple instructions.

## THE DROP BACK METHOD

When a fish is hooked on an outside or middle line anglers have another board management option to consider commonly referred to as the "drop back" method. Instead of clearing inside lines to make room to fight a fish on the outside board, try free spooling the inside line or lines allowing them to drop back far enough from the boat that the fish on an outside board line can be reeled in. The "drop back" method saves time clearing lines, but it's most practical to apply this method when fishing with short to moderate trolling leads.

Once the fish is landed using the "drop back" method that line is reset and becomes the inside line. When using the "drop back" method board lines end up getting flip flopped as fish are hooked, landed and the lines reset.

Pros tend to use the "drop back" method because it saves time and keeps their lures fishing 100% of the time.

## SUMMING IT UP

The OR12 Side Planer is America's favorite planer board. Following these simple rules of the road puts the focus on catching fish and all but eliminates frustrating line tangles.

# CLEAR WATER STRUCTURE TROLLING STRATEGY — CONTINUED FROM PAGE 9

## DON'T BE SHY, GET THEM LOW

The WIDE and LONG tactics apply to walleye suspending and feeding on smelt or emerald shiners. But the vast majority of my success on northern Lake Huron comes while targeting goby rich bottom structure. While I may troll the open water on occasion, I tend to really key in on the offshore humps, points, deep break-lines, or any other anomalies that I suspect are holding a few fish.

One fantastic bit of technology that I utilize on a daily basis is the Precision Trolling Data App (PTD). This depth chart enables me to precisely locate my chosen crankbait or crawler harness presentations just over top of holding structure. With a quick reference of this phone app, you can ensure that your baits will be running at the proper depth. The PTD app is available for both Android and iPhone users.

To get the most from the PTD app your trolling reel must be calibrated and loaded using the same diameter line featured in the app! To learn how to calibrate a line counter reel, visit the [www.precisiontrollingdata.com](http://www.precisiontrollingdata.com) site and watch a short video.

I work hard at keeping my baits within a foot or two of bottom when targeting Great Lakes structure walleye. Keeping baits in that zone is a priority for me on crystal clear flat water. On some days, if I'm not grinding bottom, and hanging up baits on occasion, I simply won't get bit.

I have my boards rigged up with the adjustable Off Shore Tackle OR12TF Tattle Flags™. The OR12TF Tattle Flag™ is a spring loaded strike indicator that reacts reliably, letting me know when my baits are ticking bottom, when they have picked up debris, or if they are being attacked by bait stealing gobies.

## DOWNSIZE

Bigger isn't always better! I see tons of walleye in the cleaning station whose bellies are chock full of gobies ranging from 1 ½ to 3 inches in length. That being the primary forage, showing a little more stealth is sometimes all you need to put a few more fish in the boat. My hands down favorite presentation is a crawler harness tied up with #5 Bugsy's

Baits Colorado Blade; however, there are days when I have to drop it down to a #4 or even a #3 to get the fish to fire up.

The same holds true for cranks. I find that clear water walleye will hit on the larger profile baits like the 700 and 800 series Reef Runners, or DDHJ12 Rapala's, but my catch ratio often skyrockets when I drop the sizes down a bit, particularly on the flat calm bright sunny days.

Line visibility also matters. Try adding a 20 foot length of 10 lb. test fluorocarbon as a leader.

Embrace the challenge! Consistently catching fish in clear water can be tough to do, but running long leads, really wide board spreads, and fishing structure will certainly tip the odds in your favor. Checking baits, bumping bottom, experimenting with presentations, and even hanging up a bait or two once in awhile is all part of the program! Take these tips and go fishing on some clear water in your area. Seeing your OR12 Side Planers sliding out of formation tail down with a fat and sassy walleye in tow will be worth the effort!



Be prepared when you hit the water – purchase your Off Shore Tackle Company LLC products at your local dealer or send in your order today!

Prices in effect January 1, 2017 through December 31, 2017



-----**Order Blank**-----

MODEL NUMBER	DESCRIPTION	UNIT PACKAGE	NUMBER OF PKGS. ORDERING	PRICE	EXTENDED AMOUNT
OFF SHORE TACKLE COMPANY LLC SIDE PLANER BOARD PRODUCTS					
OR34	Mini Planer Board; One Board...Dual Purpose...I'm Reversible	Pkg. of 1		\$17.15	
OR12L	Side Planer Left	Pkg. of 1		\$39.25	
OR12R	Side Planer Right	Pkg. of 1		\$39.25	
OR12P2	Pigtail and Split Ring For OR12L and OR12R	Pkg. of 2		\$3.85	
OR12TF	Tattle Flag Upgrade Kit	Pkg. of 1		\$27.10	
OR12TFEK	Tattle Flag ECONOMY KIT (No OR16's or Flag Included)	Pkg. of 1		\$9.99	
ORS2	Tattle Flag Replacement Spring	Pkg. of 2		\$7.75	
OR37L	SST Pro Mag Planer Left	Pkg. of 1		\$56.15	
OR37R	SST Pro Mag Planer Right	Pkg. of 1		\$56.15	
OFF SHORE TACKLE COMPANY LLC PLANER BOARD AND SIDE PLANER BOARD RELEASES					
OR3	Light Tension, White With Quick Clip	Pkg. of 2		\$16.00	
OR3BWW	Light Tension, White With Quick Clip	Pkg. of 50		\$380.60	
OR3BWOW	Light Tension, White Without Quick Clip	Pkg. of 50		\$377.60	
OR17BWW	Medium Tension, Black With Quick Clip	Pkg. of 24		\$182.50	
OR17BWOW	Medium Tension, Black Without Quick Clip	Pkg. of 24		\$181.06	
OR30BWW	Heavy Tension, Red With Quick Clip	Pkg. of 6		\$54.85	
OR30BWOW	Heavy Tension, Red Without Quick Clip	Pkg. of 6		\$54.49	
OR18	Snapper Adjustable Tension, Black	Pkg. of 1		\$15.60	
OR10	Adjustable Light Tension, Yellow With Split Ring and Quick Clip	Pkg. of 4		\$22.50	
OR10BWW	Adjustable Light Tension, Yellow With Split Ring and Quick Clip	Pkg. of 100		\$545.80	
OR10BWOW	Adjustable Light Tension, Yellow Without Split Ring and Quick Clip	Pkg. of 100		\$536.80	
OR14	Adjustable Medium Tension, Black With Split Ring and Quick Clip	Pkg. of 4		\$22.50	
OR14BWW	Adjustable Medium Tension, Black With Split Ring and Quick Clip	Pkg. of 100		\$545.80	
OR14BWOW	Adjustable Medium Tension, Black Without Split Ring and Quick Clip	Pkg. of 100		\$536.80	
OR19	Adjustable Heavy Tension, Orange With Split Ring and Quick Clip	Pkg. of 2		\$11.60	
OR19BWW	Adjustable Heavy Tension, Orange With Split Ring and Quick Clip	Pkg. of 100		\$545.80	
OR19BWOW	Adjustable Heavy Tension, Orange Without Split Ring and Quick Clip	Pkg. of 100		\$536.80	
OFF SHORE TACKLE COMPANY LLC PRO SNAP WEIGHT PRODUCTS					
OR20	Pro Snap Weight System	Pkg. of 1		\$47.70	
OR16	Extra Heavy Pro Snap Weight Clip, Red With Split Ring	Pkg. of 2		\$13.45	
OR16BWW	Extra Heavy Pro Snap Weight Clip, Red With Split Ring	Pkg. of 100		\$596.00	
OR16BWOW	Extra Heavy Pro Snap Weight Clip, Red Without Split Ring	Pkg. of 100		\$593.00	
OR20 1/2	1/2 Ounce Replacement Pro Guppy Weight	Pkg. of 3		\$4.10	
OR20 3/4	3/4 Ounce Replacement Pro Guppy Weight	Pkg. of 3		\$4.50	
OR20 1	1 Ounce Replacement Pro Guppy Weight	Pkg. of 3		\$5.00	
OR20 1 1/2	1 1/2 Ounce Replacement Pro Guppy Weight	Pkg. of 2		\$4.70	
OR20 2	2 Ounce Replacement Pro Guppy Weight	Pkg. of 2		\$5.20	
OR20 3	3 Ounce Replacement Pro Guppy Weight	Pkg. of 1		\$3.90	

Continued on reverse



These items, replacement parts, & promotional items (including apparel) are available through our website. Visit us at **www.offshoretackle.com**

★ SHOP ANYTIME ON-LINE . . . CONVENIENT AND SECURE ★



Be prepared when you hit the water – purchase your Off Shore Tackle Company LLC products at your local dealer or send in your order today!



Prices in effect January 1, 2017 through December 31, 2017



ORDER BLANK CONTINUED FROM PRIOR PAGE

MODEL NUMBER	DESCRIPTION	UNIT PACKAGE	NUMBER OF PKGS. ORDERING	PRICE	EXTENDED AMOUNT
OFF SHORE TACKLE COMPANY LLC RESETTABLE DIVING WEIGHTS					
OR36 1	Tadpole Size 1	Pkg. of 1		\$7.30	
OR36 2	Tadpole Size 2	Pkg. of 1		\$7.55	
OR36 3	Tadpole Size 3	Pkg. of 1		\$12.87	
OR36 MAGNUM	Tadpole MAGNUM Size	Pkg. of 1		\$12.99	
OFF SHORE TACKLE COMPANY LLC SINGLE DOWNRIGGER RELEASES					
OR4	Light Tension, White	Pkg. of 1		\$9.95	
OR1	Medium Tension, Black	Pkg. of 1		\$9.95	
OR8	Heavy Tension, Red	Pkg. of 1		\$14.00	
OFF SHORE TACKLE COMPANY LLC STACKER DOWNRIGGER RELEASES					
OR7	Light Tension, White	Pkg. of 1		\$16.20	
OR2	Medium Tension, Black	Pkg. of 1		\$16.20	
OFF SHORE TACKLE COMPANY LLC REPLACEMENT PADS					
ORRP8	Pads For OR1's, OR2's, OR3's, OR4's, OR7's, OR8's, OR17's, and OR30's	Pkg. of 8		\$3.60	
ORRP8SN	Pads For OR18's	Pkg. of 8		\$8.50	
ORRP16	Pads For OR10's, OR14's, and OR19's, Along With OR16's WITHOUT Pin Protruding Through The Center Of The Pad	Pkg. of 16		\$4.60	
ORRP16HL	Pads For OR16's WITH Pin Protruding Through The Center Of The Pad	Pkg. of 16		\$6.20	

Prices and packaging subject to change without notice.

These items, replacement parts, and promotional items (including apparel) are all available through our website.



PLEASE VISIT US AT ...

www.offshoretackle.com

★ SHOP ANYTIME ON-LINE ... CONVENIENT & SECURE ★

Product Total

Shipping Charges Within The 48 Mainland United States \$8.99

Subtotal (Product Total Plus Shipping Charges)

Michigan Residents and Orders Being Shipped to a Mich. Address from Non Residents, Add 6% Sales Tax Based On Subtotal

Total (Subtotal Plus Sales Tax) U. S. Funds Enclosed

ONLY ACCEPTING ORDERS BEING SHIPPED TO AN ADDRESS WITHIN THE U.S.A.

Send THIS completed order form, along with your U.S.P.S. money order or COMPLETE credit card information to:  
Off Shore Tackle Company LLC, P.O. Box 88, Port Austin, MI 48467-0088  
Please allow 2-3 weeks for delivery.

MAILING ADDRESS (Check here if this is an address change):

Name:

c/o:

Address:

City: State: ZIP:

Telephone: ( ) -

E-Mail Address:

SHIP ORDERTO (Must have street address for UPS/FedEx delivery):

Name:

c/o:

Address:

City: State: ZIP:

Telephone: ( ) -

How did you hear about us?

Please check:  
Residence  
Work  
Other

Your mailing address MUST match the address that your credit card bill is mailed to – no exceptions.

Please check: To charge your order on your MasterCard or Visa, enter your credit card number, expiration date, card ID number and sign below, or call 989-738-5600.

MasterCard Number Exp. Date: ID Number:

Visa Signature (ID Number is usually located on the backside of your MasterCard or Visa after your credit card number [3 Digit Code]).





# Riviera Product Showcase

## Dual Planer Board Masts

**Kachman Automatic Retrieval Reels With Collapsible Aluminum Mast, Base, Deck Plate and Four Hold Down Knobs (Shown right)**

Unit Includes:

- Aluminum Pulley Brackets
- 7' Collapsible Aluminum Black Powder Coated Mast
- Nylon Mounting Bracket
- Kachman Automatic Retrieval Reels
- 150' Fluorescent Orange 200# Planer Line On Each Reel Multidirectional Pulleys
- Stainless Steel Guid Bushings
- Two OR10 Adjustable Light Tension Planer Board Releases

This Unit Is Available in Different Base Options

**Model # DPMKA**  
Has The Regular Base

**Model # DPMKSA**  
Has the Springfield Taper-Lock Seat Mount

**Model # DPMKSLA**  
Has The Springfield Spring-Lock Seat Mount

**Model # DPMKSUA**  
Has The Springfield Uni-Lock Seat Mount

**Model # DPMKSZA**  
Has The Attwood Swivl-Eze 2 3/8" Seat Mount

**Aluminum Manual Retrieval Posi-Stop Reels, Collapsible Mast, Base, Deck Plate and Four Hold Down Knobs (Shown right)**

Unit Includes:

- Aluminum Pulley brackets
- 7' Collapsible Aluminum Black Powder Coated Mast
- Nylon Mounting Bracket
- Aluminum Manual Posi-Stop Retrieval Reels
- 150' Fluorescent Orange 200# Planer Line On Each Reel
- Multidirectional Pulleys
- Stainless Steel Guide Bushings
- Two OR10 Adjustable Light Tension Planer Board Releases

This Unit Is Available in Different Base Options

**Model # DPMPA**  
Has The Regular Base

**Model # DPMPSA**  
Has The Springfield Taper-Lock Seat Mount

**Model # DPMPSLA**  
Has The Springfield Spring-Lock Seat Mount

**Model # DPMPSUA**  
Has The Springfield Uni-Lock Seat Mount

**Model # DPMPSZA**  
Has The Attwood Swivl-Eze 2 3/8" Seat Mount



## Base Options



## Swiveling Rod Tower

This unit incorporates our swiveling base that allows the tower to swivel and lock up every 90 degrees with easy removal of the tower by simply pulling out a spring loaded pin and lifting. Unit is made of black powder coated aluminum for durability with all rod holders being adjustable in 15 degree increments. Tower can be used on both port and starboard sides!

**Model # SRT3**  
Has 3 Adjustable Rod Holders

**Model # SRT4**  
Has 4 Adjustable Rod Holders

**Model # SRT5 (Shown)**  
Has 5 Adjustable Rod Holders

**Model # SRT6**  
Has 6 Adjustable Rod Holders

**Model # SRTRH**  
Extra Rod Holder With Indexing Bracket

**Model # SRTTA**  
Track Adapter For SRT That Fits Most Tracks



## Track Mount For RCPK And RCWIRE

**Model # TM**  
Track Mount

This 6" track permanently mounts to your, gunwale, hard top, fly bridge or radar arch of your boat. The RCPK or RCWIRE is mounted to the track's adapter and is easily put into use or removed.

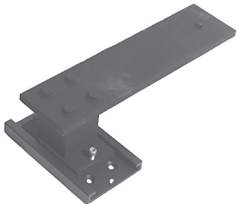

## Planer Board Rail Clamp Mounts

**Model #RCPK**  
Kachman Automatic Retrieval Reels With Rail Clamp Mount

Unit Includes:

- Kachman Automatic Retrieval Reels
- 150' Fluorescent Orange 200# Planer Line
- Aluminum Clamp Bracket That Fits 3/4" to 1 1/4" Rails



**Model #RCP**  
**Aluminum Manual Retrieval Posi-Stop Reels**

Unit Includes:

- Aluminum Manual Retrieval Posi-Stop Reels
- 150' Fluorescent Orange 200# Planer Line
- Aluminum Clamp Bracket That Fits 7/8" to 1" Rails

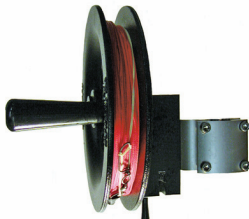

## Dual and Triple Planer Boards

**Model # DPB**  
**Dual Planer Board—Collapsible For Easy Storage**



**Model # TPB**  
**Triple Planer Board—Collapsible For Easy Storage**



The DPB's and TPB's are used in conjunction with a mast system. They are ballasted so the nose is slightly raised to cut through the waves easier and have a 3 position tow point to allow you to adapt to different water conditions instantly. To store, simply fold the outside board forward. Each board can be used on either port or starboard. A sample OR10 Adjustable Light Tension Planer Board Release comes with each DPB; a sample OR30 Heavy Tension Planer Board Release comes with each TPB.

## Hand/Wire Line Reels



**Model # RCWIRE**  
**Kachman Automatic Retrieval Hand Line Reel Kit**

Unit Includes:

- Kachman Automatic Retrieval Reel
- 200' Coated 60# Wire With Snap Swivel Termination
- 5' Pro Shank
- Aluminum Clamp Bracket That Fits 3/4"-1 1/4" Rails
- Tempress Rod Holder Adapter Replacement Parts Available

**Model # WGHT**  
**1 1/4 Pound Weight**

**Model # SHNK**  
**5' Pro Shank**



# WALLEYE FOR WOUNDED HEROES

BY MARK ROMANACK

The annual Walleye for Wounded Heroes event held out of Little Ted’s Cabins near Port Clinton, Ohio continues to grow in part to a number of Off Shore Tackle pro staffers who volunteer their time for this worthy cause.

Walleye for Wounded Heroes is a non-profit group of tournament anglers, charter captains, members of the media, local business owners and citizens who come together once a year for the purpose of sponsoring a fishing event aimed at honoring American military, police, fire and other first responders who have been injured in the line of duty. Nearly 100 injured American heroes and twice as many volunteers and sponsors come together each June on Lake Erie to help the healing process by doing what Lake Erie anglers do best.... catching walleye and sharing the fun with others!

Two stand up individuals, Joe Stelzer and Ferd Lohman, coordinate this annual event and deserve special credit for recognizing a need to honor those who serve America on foreign soils and also at home. Both men are on staff at Off Shore Tackle. A few other noteworthy Off Shore Tackle staffers who participate in the annual event include Mark, Jake and Mari Romanack, Gabe VanWormer, Darrell Wood, Mark Brumbaugh, Kurt Doller, Ali Shakoor, Jay Couch and Rhonnie Rhodes.

Off Shore Tackle is proud to be involved in Walleye for Wounded Heroes and encourages everyone to support our troops, police, fire and first responders for their service. To learn more about Walleye for Wounded Heroes, contact Ferd Lohman or Joe Stelzer on Facebook.



Captain Jake Romanack with two of America’s finest during the annual Walleye for Wounded Heroes event hosted by Little Ted’s Cabins near Port Clinton, Ohio.

## DOWNRIGGER TRICKS

BY MICHAEL COLLINS

I love the OR8 Heavy Tension Downrigger Releases (red) for pulling dodgers when fishing lake trout. Sometimes however it can be tough to see when you’ve hooked a small trout. A simple fix is to place a Dipsy Diver rubber snubber to the top swivel on the cable termination. Next place the heavy snap on the

OR8 to the snubber. This incorporates a little “give” into the system and makes it much easier for the rod tip to buck when a small fish is hooked.

When bumping downrigger balls on bottom, I also recommend attaching a rubber snubber between the cable termination and the ball. This helps keep my trailing presentation up off the bottom a little and free of gear fouling zebra mussels.

## NIGHT VISION

BY CAPTAIN TERRY KUNNEN,  
TKO CHARTERS.COM

Walleye anglers across the Midwest spend considerable time chasing walleye after dark with the help of in line boards like the famous Off Shore Tackle OR12 Side Planer. Detecting strikes when fishing in low light conditions calls for some ingenuity.

For simplicity and effectiveness, my favorite addition to all of my Off Shore Tackle planer boards is to stick a piece of United States Coast Guard approved retro-reflective tape on both sides of every planer board flag. The bow and stern lights on a boat are just enough illumination to create an easy to see reflection from the flags, making it easy to see when a fish is hooked and a board sags from the weight of a fish.

Most marine supply stores have this tape available. I’ve found that USCG approved tape seems to be a better grade of tape and it has superior reflection value versus some of the other reflector tapes on the market.

Placing a strip of tape on both sides of the flag makes it easy for me to monitor my boards to determine strikes and also for other anglers around me to recognize that I’m trolling with boards. Rigging my boards this way for night trolling works great, doesn’t require batteries, lasts forever and doesn’t cost much. Now that’s a combination any angler can appreciate.

## IN LINE WEED BLOCKERS

BY MARK ROMANACK

Anyone who has spent much time trolling knows that floating weeds and other debris have a nasty habit of catching on the fishing line and eventually fouling those trailing lures. The reason this occurs so commonly is that monofilament, co-polymer and super lines so commonly used for trolling are buoyant and float near the surface.

Say for example an angler is trolling a crankbait 100 feet behind the boat. Most of that 100 foot lead length is floating at or near the surface. Only the last few feet of the trolling lead actually angles down in the water. The folks at Precision Trolling Data documented this fact decades ago when they first started documenting the diving depth of trolling gear using modern scuba techniques.

Because the line is at the surface, anything floating on or near the surface can easily catch on the fishing line. A simple way to solve this common problem is to let out the crankbait or other lure about half way. Take an OR10 (yellow) Light Tension Planer Board Release and clip it onto the fishing line. Let out the rest of the trolling lead and then hook the line up to an in line board or dual/triple style planer board trolling rig.

The OR10 release provides little resistance in the water and when weeds or other debris catch on and slide down the line, the debris gets blocked and can’t slide the rest of the way to the lure.

This simple trick can be performed using any of the Off Shore Tackle line releases and clips including the OR10, OR14, OR19 and OR16. Lots of anglers use older releases with worn out pads for this purpose.

When a fish is hooked, the angler simply needs to remove the line release when it comes to the rod tip. This super simple, yet highly effective way of trolling among floating weeds and debris is just another way Off Shore Tackle is your leader in trolling technology.

Be prepared when you hit the water – purchase your Riviera Trolling Systems products  
at your local dealer or send in your order today!

Prices in effect January 1, 2017 through December 31, 2017



# Order Blank

MODEL NUMBER	DESCRIPTION	UNIT PACKAGE	NUMBER OF PKGS. ORDERING	PRICE	EXTENDED AMOUNT
RIVIERA DUAL PLANER BOARD MASTS					
DPMKA	7' Collapsible Aluminum Black Powder Coated Mast With Kachman Automatic Retrieval Reels With Regular Base	Pkg. of 1		\$435.00	
DPMKSA	Fits With Springfield Taper-Lock Seat Mount	Pkg. of 1		\$435.00	
DPMKSLA	Fits With Springfield Spring-Lock Seat Mount	Pkg. of 1		\$435.00	
DPMKSUA	Fits With Springfield Uni-Lock Seat Mount	Pkg. of 1		\$435.00	
DPMKSZA	Fits With Attwood Swivl-Eze 2-3/8" Seat Mount	Pkg. of 1		\$435.00	
DPMPA	7' Collapsible Aluminum Black Powder Coated Mast With Manual Posi-Stop Reels With Regular Base	Pkg. of 1		\$325.00	
DPMPSA	Fits With Springfield Taper-Lock Seat Mount	Pkg. of 1		\$325.00	
DPMPSLA	Fits With Springfield Spring-Lock Seat Mount	Pkg. of 1		\$325.00	
DPMPSUA	Fits With Springfield Uni-Lock Seat Mount	Pkg. of 1		\$325.00	
DPMPSZA	Fits With Attwood Swivl-Eze 2-3/8" Seat Mount	Pkg. of 1		\$325.00	
RIVIERA SWIVELING ROD TOWER					
SRT3	With 3 Adjustable Rod Holders	Pkg. of 1		\$180.00	
SRT4	With 4 Adjustable Rod Holders	Pkg. of 1		\$225.00	
SRT5	With 5 Adjustable Rod Holders	Pkg. of 1		\$265.00	
SRT6	With 6 Adjustable Rod Holders	Pkg. of 1		\$305.00	
SRTRH	Extra Adjustable Rod Holder With Index Brackets	Pkg. of 1		\$49.00	
SRTTA	Track Adapter For SRT That Fits Most Tracks	Pkg. of 1		\$49.00	
RIVIERA TRACK MOUNT					
TM	Track Mount For RCPK or RCWIRE	Pkg. of 1		\$49.00	
RIVIERA PLANER BOARD RAIL CLAMP MOUNTS					
RCPK	Kachman Automatic Retrieval Rail Clamp	Pkg. of 1		\$175.00	
RCPP	Manual Retrieval Rail Clamp With Aluminum Black Powder Coated Posi-Stop Reels	Pkg. of 1		\$98.00	
RIVIERA DUAL AND TRIPLE PLANER BOARDS					
DPB	Dual Planer Board - Collapsible For Easy Storage	Pkg. of 1		\$75.00	
TPB	Triple Planer Board - Collapsible For Easy Storage	Pkg. of 1		\$98.00	
RIVIERA HAND LINE REELS					
RCWIRE	Kachman Automatic Hand Line Reel With Rail Clamp Mount, Wire, Weight, Shank, and Rod Holder Adapter	Pkg. of 1		\$195.00	
WGHT	1 1/4 Pound Weight	Pkg. of 1		\$6.00	
SHNK	5' Pro Shank	Pkg. of 1		\$5.00	

*SHIPPING CHARGES WITHIN THE 48 MAINLAND UNITED STATES:	MERCHANDISE TOTAL	SHIPPING CHARGE
	\$0.01 - \$15.00 .....	\$8.00
	\$15.01 - \$30.00 .....	\$9.00
	\$30.01 - \$50.00 .....	\$10.00
	\$50.01 - \$80.00 .....	\$11.00
	\$80.01 - \$100.00 .....	\$12.00
	\$100.01 - \$200.00 .....	\$13.00
	\$200.01 - \$300.00 .....	\$14.00
	\$300.01 - \$400.00 .....	\$15.00
	\$400.01 - \$500.00 .....	\$16.00
	Over \$500.00 .....	FREE

Product Total \_\_\_\_\_

\*Shipping Charges \_\_\_\_\_

Subtotal (Product Total Plus Shipping Charges) \_\_\_\_\_

**Michigan Residents and Orders Being Shipped to a  
Michigan Address from Non Residents, Add 6% Sales Tax  
Based On Subtotal** \_\_\_\_\_

Total (Subtotal Plus Sales Tax) U. S. Funds Enclosed

\*For orders being shipped outside of the 48 mainland United States, please call for shipping charges. Duties and taxes will be your responsibility.  
Send THIS completed order form, along with your U.S.P.S. money order, check, (**sorry, no out of country money orders or checks can be accepted**),  
or COMPLETE credit card information to:

Riviera Trolling Systems Incorporated  
P.O. Box 507, Port Austin, MI 48467-0507

Orders will be released upon clearance of checks, please allow 2-3 weeks for delivery.

Credit card orders are normally shipped within 5 business days of receipt of order.

MAILING ADDRESS (Check here \_\_\_\_\_ if this is an address change):

SHIP ORDER TO (Must have street address for UPS/FedEx delivery):

Please check:

Name: \_\_\_\_\_

Name: \_\_\_\_\_

\_\_\_ Residence

c/o: \_\_\_\_\_

c/o: \_\_\_\_\_

\_\_\_ Work

Address: \_\_\_\_\_

Address: \_\_\_\_\_

\_\_\_ Other

City: \_\_\_\_\_ State: \_\_\_\_\_ ZIP: \_\_\_\_\_

City: \_\_\_\_\_ State: \_\_\_\_\_ ZIP: \_\_\_\_\_

Telephone: ( \_\_\_\_\_ ) \_\_\_\_\_ - \_\_\_\_\_

Telephone: ( \_\_\_\_\_ ) \_\_\_\_\_ - \_\_\_\_\_

E-Mail Address: \_\_\_\_\_

How did you hear about us? \_\_\_\_\_

**Your mailing address MUST match the address that your credit card bill is mailed to – no exceptions.**

Please check:

To charge your order on your American Express, Discover, MasterCard or Visa, enter your credit card number,  
expiration date, card ID number and sign below, or call 989-738-5700.

\_\_\_ American Express

\_\_\_ Discover

\_\_\_ MasterCard

\_\_\_ Visa

Number \_\_\_\_\_ Exp. Date: \_\_\_\_\_ ID Number: \_\_\_\_\_

Signature \_\_\_\_\_

(ID Number is located on the backside of your Discover, MasterCard or Visa after your credit card number [3 Digit Code];  
on American Express it is located on the front of your card usually to the upper right of your card number [4 Digit Code]).



# LETTER FROM THE CHAIRMAN OF THE BOARDS, BRUCE DESHANO

The 2017 fishing season is upon us and everyone at Off Shore Tackle LLC is looking forward to another great year. Our media partners and pro staffers have done an excellent job of showcasing the entire Off Shore Tackle product line up.

Many of you may have had the opportunity to visit with one or more of our pro staffers at sport shows, fishing club seminars or tackle retailers. My personal favorite is when our pro staffers take time from their busy schedules to provide impromptu "boat ramp seminars" aimed at helping others be more successful on the water.

I would like to take this opportunity to thank all the Off Shore Tackle team members. Our team of fishing professionals stretches coast to coast and these dedicated men and women have done a wonderful job of representing Off Shore Tackle to the public, media and fellow anglers. Currently our pro staff represents professional anglers who are actively targeting walleye, crappie, muskie and a host of cold water species.

In 2016 Nick and I enjoyed fishing the Crappie Masters tournament trail and look forward to competing again in 2017. We have learned a lot about crappie fishing and crappie anglers by fishing this circuit and getting to know the major players.

It is amazing how much interest crappie anglers have in using Off Shore Tackle planer boards and tadpole divers south of the Mason Dixon Line. Catfish anglers are another group that see the value of using our products for trolling, drifting and river fishing applications.

Our staff of "championship caliber" professional anglers are tasked with sharing their knowledge of fishing with others. Pro staffers are also responsible for helping Off Shore Tackle brainstorm, design and develop new and insightful products for the future.

Off Shore Tackle has enjoyed amazing success in recent years and 2017 is no exception. New for 2017 the OR38 Awesome Crappie Board will take planer board fishing to a whole new level. Also, don't forget to check out some unique refinements to the wildly popular Tattle Flag™ System implemented for 2017. The latest generation of Tattle Flags™ provide even more spring tension settings perfect for trolling all types of gear and at all common trolling speeds.

Copied by many, but never duplicated... At Off Shore Tackle product innovation is just one of the reasons we're known as the "The Leaders in Trolling Technology."



## ABOUT THE EDITOR

Outdoor writer turned TV host, Mark Romanack is the editor of the Off Shore Release. Mark lives in northern Michigan where he spends the majority of his time creating TV episodes for the Fishing 411 television series as seen on World Fishing Network.

Fishing 411 is a nationally broadcast TV series, produced by Mark and his staff Jake Romanack, Mari Romanack and Gabe VanWormer. Fishing 411 has a national flavor, but the majority of the episodes are shot in the Great Lakes region near Mark's Michigan home.

Off Shore Tackle LLC is the title sponsor of Fishing 411 and a long time supporter of Mark's media efforts. Fishing 411 is currently broadcasting season No. 10 and can be found on World Fishing Network through Dish Network and also select cable providers. For those who's TV package doesn't include WFN, the Fishing 411 episodes can all be seen free of charge on line at [www.fishing411.net](http://www.fishing411.net). Simply click on the TV Episode menu and select from dozens of online episodes free of commercial content.

Fishing 411 is also available on CarbonTV and on demand TV provider who specializes in premium outdoor programming. CarbonTV is a free service to the consumer and can be accessed at [www.carbontv.com](http://www.carbontv.com).

Anglers who would like to meet Mark and his staff in person should check the [www.fishing411.net](http://www.fishing411.net) web page for an updated listing of public speaking engagements for 2017. Mark and his staff will appear at a host of outdoor boat, sport and fishing shows during the winter of 2017. The entire 411 staff stay active on all the social networking outlets and can be reached at both the Fishing 411 and Mark Romanack professional Facebook pages.



# TROLLING CRANKBAITS COVERS WATER AND CATCHES WALLEYE

BY JAKE BRANDT

Trolling crankbaits for walleye is among the most “efficient” presentation in a walleye angler’s arsenal. Trolling enables anglers the ability to maximize their fishing efforts, cover more water and find fish quickly.

Adding in multiple Off Shore Tackle OR12 Side Planers to the equation helps me cover even more water by spreading baits out away from the boat. Off Shore boards also allow me to run the maximum number of rods allowed by law per person. This in turn permits me to cover the entire water column to determine the best depth to target active fish.

Before I even put a crankbait in the water I drive around and look for fish with my electronics. Once I mark fish, I observe the depth at which the majority of them are holding. I’ll target this depth and put all but two of my baits near this area. Keep in mind that fish prefer to feed upwards in the water column, so set baits slightly above the depth where most of the fish are suspending.

Regardless of what my graph is marking, I always put a bait in the top five feet of the water column. I always run a crankbait near the surface because it’s difficult for electronics to mark fish in this subsurface micro-habitat. It’s hard to mark fish close to the surface because the sonar cone angle and coverage area is small at these depths. The only way to know if there’s fish high in the water column is to run a bait there and see what happens.

I recommend running this shallow bait on an outside board. This helps to reduce the chances of spooking high fish with the boat. The top of the water column deserves a “look see” any time suspended fish are showing up on the graph, but don’t limit yourself to fishing only the high fish and the one’s marking on sonar.

Walleye often hold on bottom even when the majority of the fish in the area are suspending. Bottom hugging

walleye are often lethargic, but crankbaits can also be used to trigger a reaction strike out of these reluctant fish. Fish pulled from the bottom tend to be small in number, but they are often among the biggest fish in the catch.

When fishing cranks near bottom I recommend fishing this as a high line rather than running it on a planer board. With this bait running near bottom it’s far enough behind the boat that there is no worry regarding the boat spooking the fish. This set up also makes it easy to run baits close to bottom and quickly change lead lengths as the bottom contour changes. Unfortunately, a lot of crankbaits don’t dive deep enough on their own to reach bottom or even deep suspended fish. To solve this problem, I turn to the Off Shore Tackle OR20 Pro Weight System.

The Pro Weight System is a kit containing an assortment of “Guppy Weights”, split rings and four OR16 Pro Snap Weight Clips. The OR16 clips come with a pin in the center. As long as the line is placed behind the pin it will prevent the clip and weight from coming off the line.

Guppy weights are available in 1/2, 3/4, 1, 1 1/2, 2 and 3 ounce sizes. Regardless of which weight I choose I always keep it consistent throughout my program. I keep all of my weights the same to decrease the number of variables in the equation.

While I’m trying to figure out the best depth to catch fish I’m also trying to determine the best crankbait. I start out with every single one of my rods having a different lure. I’ll try a variety of body styles from short wide shad bodies up to long skinny minnow bodies. Walleye will often key in on whatever prey is most abundant and to catch fish anglers need to match the hatch. I research forage availability whenever I fish a new body of water. This gives me a heads up on which type of crankbaits may work best. If I’m unable to find much information, then trial and error along with observations is my only option.

Different styles of lures not only vary in shape and size, but they also have different actions. From tight subtle wobbles to aggressive eradicate jerks every crankbait has its own unique movement. These different actions not only appear different visually but also vibrate differently.

All fish have an organ called a lateral line, located just beneath the skin that enables them to feel vibrations in their surrounding environment. The lateral line allows them to find prey and also to detect predators.

On any given day fish may be more responsive to the vibration pattern of one bait over another. Finding the bait with the proper vibration can make all the difference in turning a slow bite into a feeding frenzy. Once I find the crankbait with the right shape and vibration I can finally start to work on isolating the best lure colors.

Location, speed, depth and bait type are much more important than color when dialing walleye in with crankbaits. Once I start to search for the best color I’ll start with a wide array of colors from bright shiny metallic baits to solid opaque natural ones. Sunlight, water clarity and forage availability will be the most important factors in finding the best color for current conditions.

Finding and figuring out walleye is a process that, if done correctly, will lead to putting a lot more walleye in the boat. Trolling crankbaits is my go to presentation when arriving to any body of water. Trolling cranks allows me to maximize my fishing efforts which helps me find active fish quickly.

Off Shore Tackle OR12 Side Planers and the OR20 Pro Weight System allow me to spread out my baits not only horizontally, but also throughout the vertical water column. Put this process to work the next time you’re on the water and you’ll find yourself putting more walleye in the boat.

## ECONOMICS 101, FOUR OR TWO DOWNRIGGERS?

BY RON WINTERS

In most fishing situations trolling with extra lines puts more fish in the boat. charter captains prove this on a daily basis by fishing the maximum number of lines based on how many customers they have on board.

This simple strategy puts bonus fish in the boat most of the time. Fishing however is an interesting pursuit and not everything turns out to be as it seems. Fishing is made up of a lot of rules and interestingly for every rule there are often exceptions to that rule.

Downriggers are one of those fishing topics that not everyone agrees with the more is better philosophy. Even charter captains who fish as many lines as possible are reluctant to stack “too many” downriggers into their trolling pattern.

From 1982 to 2008 my fishing buddies and I fished a pair of downriggers and ran them each with two rods. Our primary targets were landlocked salmon on Lake Champlain and kings on Lake Ontario. Around 2009 we came to the conclusion that we could catch more fish by adding two additional riggers and dedicating one rod to each rigger. A few more years down the road and our group is seriously rethinking that strategy. With the multitude of delivery systems now available our “rigger heavy” strategy it appears has reduced our opportunities for larger king salmon. Unfortunately, I had to learn this lesson the hard way fishing tournaments against some talented and forward thinking anglers.

By reviewing some of what I learned in college economics, there are several parallels that also hold true in fishing!

### LAW NO. 1, THE LAW OF DIMINISHING RETURNS

The law of diminishing return states: The first candy bar tastes better than the second, third, fourth and so on. Fishing with a four downrigger set up I have taken a lot of

smaller salmon over the past eight years. The four rigger set up works well when the fish are very aggressive, but this set up produces poorer results when fishing in traffic and also when targeting fish during non-peak times of day and especially when fishing in a tougher bite.

With four riggers in the water we’re creating a significant “cone of disturbance” directly below and behind the boat. Faced with clearer and clearer water conditions and fish that are increasingly difficult to fool, more (in the case of downrigger lines) is not adding up to better these days.

It’s abundantly obvious that more and larger salmon are being caught outside the turbulence created by four downrigger weights, wires, releases, etc. Other presentations that fish both deep and out away from the boat are producing consistent action and noteworthy salmon.

### LAW NO. 2, THE LAW OF VERTICAL AND HORIZONTAL INTEGRATION

Covering water vertically is good, but it’s also important to cover as much water horizontally as possible. A solid strategy involves covering the water directly below the boat with just two downrigger lines and in turn expanding on the horizontal presentation.

Slide Divers rigged with long (25 to 50 feet) fluorocarbon leaders to compensate for clear water conditions are one of the ways anglers are getting away from the boat and catching more fish. Unlike traditional divers the Slide-Diver enables the angler to increase the lead length between the diver and the lure as necessary to catch spooky trout and salmon.

Other critical pieces of gear are the famous Off Shore Tackle OR12 Side Planer and the OR37 SST Pro Mag boards. Inline boards are ideal for presenting lead core line, copper line set ups and divers like the OR36 Tadpole Resettable Divers out away from the boat. The OR12 does an excellent job of handling No. 1, 2 and 3 Tadpole Divers and also copper line and lead core set ups out to

about 200 foot rigs. For fishing the Magnum Tadpole and longer lengths of lead core and copper line the SST Pro Mag is the board of choice.

### LAW NO. 3, MICRO OR MACRO?

Concentrating gear directly below the boat is the “micro” approach and works well when fishing the bottom for species like lake trout. This set up is especially effective when fishing attractors like dodgers and lake trolls.

Salmon on the other hand are more likely to be suspended in the water column and spreading out the rig horizontally to create a larger “macro” trolling set up produces more and bigger salmon and steelhead.

### SUMMARY

Admittedly the goal at times in the last few years was to cram 3 or 4 people in the boat and put as much gear in the water as possible. This “value added” approach of increasing bodies and lines in the water becomes a point of diminishing return much like the candy bar economic lesson I learned in college.

These days I enjoy having one guest at a time and challenging ourselves with offering both a vertical and horizontal placement of our presentations. By using just two downriggers and board lines to fill up the trolling pattern, my strategy has become more about diversification. Having four strategically placed lures vertically and horizontally in the water column helps the cause for catching larger salmon and lets us also capitalize on the “rigger bite” during peak periods.

One thing to remember is that all these delivery methods can catch fish. It’s up to each person to decide what approach is going to work best for them. With all the choices anglers have today, it’s fun to try different delivery systems.

Off Shore Tackle helps in the process by offering inline boards suitable for all open water trolling applications.



**FREE!**



Volume 24, 2017

Chairman of the Boards BRUCE DESHANO  
Vice Chairman of the Boards NICK DESHANO  
Editor MARK ROMANACK

# The **OFF SHORE** RELEASE

Your Leader In Trolling Technology [www.offshoretackle.com](http://www.offshoretackle.com)



Printed by Stafford Printing



This shot pretty much says it all. Off Shore Tackle is America's No. 1 planer board!

**Tips and Techniques brought to you by  
Your Leaders In Trolling Technology,  
Off Shore Tackle LLC  
and Riviera Trolling Systems**